



V-belt pulleys for Taper bushes

| | | |
|------------------------------|----|--------------|
| SPZ TAPER BUSH PULLEYS | Dm | 50 - 100 mm |
| | Dm | 106 - 170 mm |
| | Dm | 180 - 355 mm |
| | Dm | 400 - 800 mm |

| | | |
|------------------------------|----|--------------|
| SPA TAPER BUSH PULLEYS | Dm | 63 - 112 mm |
| | Dm | 118 - 190 mm |
| | Dm | 200 - 400 mm |
| | Dm | 450 - 800 mm |

| | | |
|------------------------------|----|---------------|
| SPB TAPER BUSH PULLEYS | Dm | 100 - 170 mm |
| | Dm | 180 - 250 mm |
| | Dm | 265 - 450 mm |
| | Dm | 500 - 1250 mm |

| | | |
|------------------------------|----|---------------|
| SPC TAPER BUSH PULLEYS | Dm | 200 - 315 mm |
| | Dm | 335 - 530 mm |
| | Dm | 560 - 1250 mm |

TAPER BUSH

DIMENSIONS

SPECIFICATIONS

MATERIAL, BALANCING, PACKING



VTP®



VTP®

Vald. Birns Maskinfabrik A/S is one of Europe's leading producers of V-belt pulleys / VTP® pulleys (Ventilated Turbo Pulley) for Taper bushes, V-belt pulleys with solid hub, and flexible couplings.

The combination of design and the selected cast iron qualities means that the products have been optimized as to weight, surface and strength.

Vald. Birns Maskinfabrik A/S belongs to the foundry group Vald. Birn A/S with a staff of approx. 1200, and has through extensive investments, also reached a position as one of Northern Europe's leading machine works within machining and surface treatment of castings.

The Vald Birn Group also includes:

Vald. Birns Jernstøberi A/S, Holstebro, Northern Europe's biggest customer foundry with an annual capacity of 60,000 tonnes.

A/S Tasso, Odense, 2 foundries with an annual capacity of 20,000 tonnes.

Vald. Birn (UK) Ltd., Newcastle with an annual capacity of 20,000 tonnes.

The sales companies Vald. Birn GmbH, Mülheim/- Ruhr in Germany and Jens S. A/S, Denmark with branches in København, Århus, Vejle and Oslo.

Vald. Birns Maskinfabrik A/S er en af Europas førende producenter af kileremskiver / VTP® kileremskiver (Ventilated Turbo Pulley) for Taper- bøsninger, kileremskiver for udboring samt elastiske koblinger.

Kombinationen af design og de valgte støbegods- kvaliteter betyder, at de enkelte produkter er optimeret m.h.t. vægt, overflade og styrke.

Vald. Birns Maskinfabrik A/S der er en del af støberikoncernen Vald. Birn A/S, med ca. 1200 ansatte, har gennem store investeringer endvidere udviklet sig til at have en position som en af Nordeuropas førende maskinfabrikker inden for bearbejdning og overfladebehandling af støbegods.

Vald. Birn koncernen består endvidere af:

Vald. Birns Jernstøberi A/S, Holstebro, der med en årskapacitet på 60.000 tons er Nordeuropas største kundestøberi.

A/S Tasso, Odense, bestående af to støberier med en samlet årskapacitet på 20.000 tons.

Vald. Birn (UK) Ltd., Newcastle, med en årskapacitet på 20.000 tons.

Salgsselskaberne Vald. Birn GmbH Mülheim Ruhr i Tyskland samt Jens S. A/S i Danmark med afdelinger i København, Århus, Vejle og Oslo.

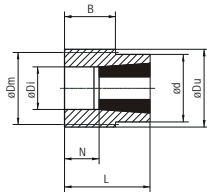

Type 0

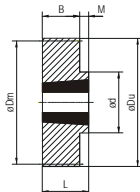

Type 1

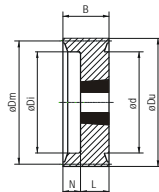

Type 3

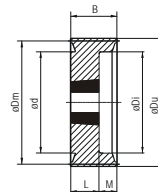

Type 4

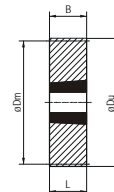

Type 6

| Code | Dm | Grooves Spor | Pulley Skive | Bush Bøsn. | Bore Udboring | Du | B | d | L | Di | M | N | Unbalance Ubalance | Weight Vægt | Matr. |
|------------|-----|-----------------|-----------------|---------------|------------------|-----|----|----|----|----|------|------|-----------------------|----------------|------------|
| EDB | mm | no./antal | type | type | mm | mm | mm | mm | mm | mm | mm | mm | gcm (max) | kg | DIN1691/93 |
| 61.0050.01 | 50 | 1 | 0 ● | 1008 | 9-25 | 54 | 16 | 60 | 37 | 25 | - | 15,0 | 1,5 | 0,3 | GG-25 |
| 61.0050.02 | 50 | 2 | 0 ● | 1008 | 9-25 | 54 | 28 | 60 | 49 | 25 | - | 27,0 | 2,0 | 0,4 | GG-25 |
| 61.0056.01 | 56 | 1 | 0 ● | 1008 | 9-25 | 60 | 16 | 60 | 37 | 30 | - | 15,0 | 2,0 | 0,4 | GG-25 |
| 61.0056.02 | 56 | 2 | 0 ● | 1108 | 9-28 | 60 | 28 | 60 | 49 | 30 | - | 27,0 | 2,5 | 0,5 | GG-25 |
| 61.0060.01 | 60 | 1 | 1 ● | 1008 | 9-25 | 64 | 16 | 55 | 22 | - | 6,0 | - | 1,0 | 0,2 | GG-25 |
| 61.0060.02 | 60 | 2 | 0 ● | 1108 | 9-28 | 64 | 28 | 64 | 49 | 34 | - | 27,0 | 3,1 | 0,6 | GG-25 |
| 61.0063.01 | 63 | 1 | 1 ● | 1108 | 9-28 | 67 | 16 | 60 | 22 | - | 6,0 | - | 1,0 | 0,2 | GG-25 |
| 61.0063.02 | 63 | 2 | 6 ● | 1108 | 9-28 | 67 | 28 | - | 28 | - | - | - | 1,5 | 0,3 | GG-25 |
| 61.0063.03 | 63 | 3 | 3 ● | 1108 | 9-28 | 67 | 40 | - | 22 | 37 | - | 18,0 | 2,0 | 0,4 | GG-25 |
| 61.0067.01 | 67 | 1 | 1 ● | 1108 | 9-28 | 71 | 16 | 60 | 22 | - | 6,0 | - | 1,5 | 0,3 | GG-25 |
| 61.0067.02 | 67 | 2 | 6 ● | 1108 | 9-28 | 71 | 28 | - | 28 | - | - | - | 2,0 | 0,4 | GG-25 |
| 61.0067.03 | 67 | 3 | 3 ● | 1108 | 9-28 | 71 | 40 | - | 22 | 41 | - | 18,0 | 2,5 | 0,5 | GG-25 |
| 61.0071.01 | 71 | 1 | 1 ● | 1108 | 9-28 | 75 | 16 | 60 | 22 | - | 6,0 | - | 1,5 | 0,3 | GG-25 |
| 61.0071.02 | 71 | 2 | 6 ● | 1108 | 9-28 | 75 | 28 | - | 28 | - | - | - | 2,0 | 0,4 | GG-25 |
| 61.0071.03 | 71 | 3 | 3 ● | 1108 | 9-28 | 75 | 40 | - | 22 | 45 | - | 18,0 | 3,1 | 0,6 | GG-25 |
| 61.0075.01 | 75 | 1 | 1 ● | 1108 | 9-28 | 79 | 16 | 60 | 22 | - | 6,0 | - | 2,0 | 0,4 | GG-25 |
| 61.0075.02 | 75 | 2 | 6 ● | 1210 | 11-32 | 79 | 28 | - | 28 | - | - | - | 2,0 | 0,4 | GGG-40 |
| 61.0075.03 | 75 | 3 | 3 ● | 1210 | 11-32 | 79 | 40 | - | 25 | 49 | - | 15,0 | 2,5 | 0,5 | GGG-40 |
| 61.0080.01 | 80 | 1 | 1 ● | 1210 | 11-32 | 84 | 16 | 75 | 25 | - | 9,0 | - | 2,5 | 0,5 | GG-30 |
| 61.0080.02 | 80 | 2 | 6 ● | 1210 | 11-32 | 84 | 28 | - | 28 | - | - | - | 3,1 | 0,6 | GG-25 |
| 61.0080.03 | 80 | 3 | 3 ● | 1210 | 11-32 | 84 | 40 | - | 25 | 54 | - | 15,0 | 3,6 | 0,7 | GG-30 |
| 61.0080.04 | 80 | 4 | 3 ● | 1210 | 11-32 | 84 | 52 | - | 25 | 54 | - | 27,0 | 4,1 | 0,8 | GG-30 |
| 61.0085.01 | 85 | 1 | 1 ● | 1210 | 11-32 | 89 | 16 | 75 | 25 | - | 9,0 | - | 3,1 | 0,6 | GG-30 |
| 61.0085.02 | 85 | 2 | 6 ● | 1610 | 14-42 | 89 | 28 | - | 28 | - | - | - | 2,5 | 0,5 | GGG-40 |
| 61.0085.03 | 85 | 3 | 3 ● | 1610 | 14-42 | 89 | 40 | - | 25 | 59 | - | 15,0 | 3,1 | 0,6 | GG-30 |
| 61.0085.04 | 85 | 4 | 3 ● | 1610 | 14-42 | 89 | 52 | - | 25 | 59 | - | 27,0 | 4,6 | 0,9 | GGG-40 |
| 61.0085.05 | 85 | 5 | 3 ● | 1610 | 14-42 | 89 | 64 | - | 25 | 59 | - | 39,0 | 5,1 | 1,0 | GGG-60 |
| 61.0090.01 | 90 | 1 | 1 ● | 1210 | 11-32 | 94 | 16 | 75 | 25 | - | 9,0 | - | 3,6 | 0,7 | GG-30 |
| 61.0090.02 | 90 | 2 | 6 ● | 1610 | 14-42 | 94 | 28 | - | 28 | - | - | - | 3,6 | 0,7 | GG-30 |
| 61.0090.03 | 90 | 3 | 3 ● | 1610 | 14-42 | 94 | 40 | - | 25 | 64 | - | 15,0 | 4,1 | 0,8 | GG-30 |
| 61.0090.04 | 90 | 4 | 3 ● | 1610 | 14-42 | 94 | 52 | - | 25 | 64 | - | 27,0 | 5,1 | 1,0 | GGG-40 |
| 61.0090.05 | 90 | 5 | 3 ● | 1610 | 14-42 | 94 | 64 | - | 25 | 64 | - | 39,0 | 6,1 | 1,2 | GG-30 |
| 61.0095.01 | 95 | 1 | 1 ● | 1210 | 11-32 | 99 | 16 | 75 | 25 | - | 9,0 | - | 3,6 | 0,7 | GG-25 |
| 61.0095.02 | 95 | 2 | 6 ● | 1610 | 14-42 | 99 | 28 | - | 28 | - | - | - | 4,1 | 0,8 | GG-30 |
| 61.0095.03 | 95 | 3 | 4 ● | 1610 | 14-42 | 99 | 40 | - | 25 | 69 | 15,0 | - | 4,6 | 0,9 | GG-30 |
| 61.0095.04 | 95 | 4 | 4 ● | 1610 | 14-42 | 99 | 52 | - | 25 | 69 | 27,0 | - | 5,6 | 1,1 | GG-30 |
| 61.0095.05 | 95 | 5 | 4 ● | 1610 | 14-42 | 99 | 64 | - | 25 | 69 | 39,0 | - | 6,6 | 1,3 | GG-25 |
| 61.0100.01 | 100 | 1 | 1 ● | 1210 | 11-32 | 104 | 16 | 75 | 25 | - | 9,0 | - | 4,1 | 0,8 | GG-25 |
| 61.0100.02 | 100 | 2 | 6 ● | 1610 | 14-42 | 104 | 28 | - | 28 | - | - | - | 4,6 | 0,9 | GG-30 |
| 61.0100.03 | 100 | 3 | 4 ● | 1610 | 14-42 | 104 | 40 | - | 25 | 74 | 15,0 | - | 5,6 | 1,1 | GG-25 |
| 61.0100.04 | 100 | 4 | 4 ● | 1610 | 14-42 | 104 | 52 | - | 25 | 74 | 27,0 | - | 5,6 | 1,1 | GG-30 |
| 61.0100.05 | 100 | 5 | 3 ● | 2012 | 14-50 | 104 | 64 | - | 32 | 74 | - | 32,0 | 6,6 | 1,3 | GG-30 |

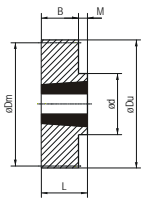

Type 1

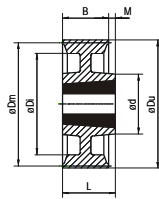

Type 2

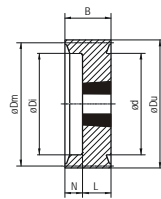

Type 3

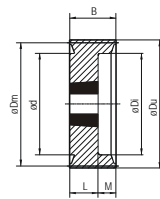

Type 4

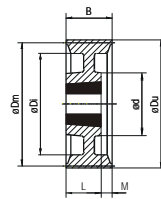

Type 5

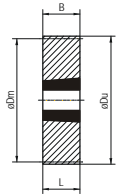

Type 6

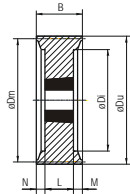

Type 7

| Code | Dm | Grooves Spor | Pulley Skive | Bush Bøsn. | Bore Udboring | Du | B | d | L | Di | M | N | Unbalance Ubalance | Weight Vægt | Matr. |
|------------|-----|--------------|--------------|------------|---------------|-----|-----|-----|----|-----|------|------|--------------------|-------------|------------|
| EDB | mm | no./antal | type | type | mm | mm | mm | mm | mm | mm | mm | mm | gcm (max) | kg | DIN1691/93 |
| 61.0106.01 | 106 | 1 | 1 ● | 1610 | 14-42 | 110 | 16 | 85 | 25 | - | 9,0 | - | 4,6 | 0,9 | GG-25 |
| 61.0106.02 | 106 | 2 | 6 ● | 1610 | 14-42 | 110 | 28 | - | 28 | - | - | - | 5,6 | 1,1 | GG-25 |
| 61.0106.03 | 106 | 3 | 4 ● | 1610 | 14-42 | 110 | 40 | - | 25 | 80 | 15,0 | - | 6,6 | 1,3 | GG-25 |
| 61.0106.04 | 106 | 4 | 4 ● | 1610 | 14-42 | 110 | 52 | - | 25 | 80 | 27,0 | - | 6,6 | 1,3 | GG-25 |
| 61.0106.05 | 106 | 5 | 3 ● | 2012 | 14-50 | 110 | 64 | - | 32 | 80 | - | 32,0 | 7,6 | 1,5 | GG-25 |
| 61.0112.01 | 112 | 1 | 1 ● | 1610 | 14-42 | 116 | 16 | 85 | 25 | - | 9,0 | - | 5,1 | 1,0 | GG-25 |
| 61.0112.02 | 112 | 2 | 6 ● | 1610 | 14-42 | 116 | 28 | - | 28 | - | - | - | 6,6 | 1,3 | GG-25 |
| 61.0112.03 | 112 | 3 | 4 ● | 2012 | 14-50 | 116 | 40 | - | 32 | 86 | 8,0 | - | 6,6 | 1,3 | GG-25 |
| 61.0112.04 | 112 | 4 | 4 ● | 2012 | 14-50 | 116 | 52 | - | 32 | 86 | 20,0 | - | 7,6 | 1,5 | GG-25 |
| 61.0112.05 | 112 | 5 | 4 ● | 2012 | 14-50 | 116 | 64 | - | 32 | 86 | 32,0 | - | 9,2 | 1,8 | GG-25 |
| 61.0118.01 | 118 | 1 | 2 ○ | 1610 | 14-42 | 122 | 16 | 85 | 25 | - | 9,0 | - | 4,6 | 0,9 | GG-25 |
| 61.0118.02 | 118 | 2 | 5 ○ | 1610 | 14-42 | 122 | 28 | 85 | 25 | - | 3,0 | - | 6,6 | 1,3 | GG-25 |
| 61.0118.03 | 118 | 3 | 4 ● | 2012 | 14-50 | 122 | 40 | - | 32 | 92 | 8,0 | - | 8,2 | 1,6 | GG-25 |
| 61.0118.04 | 118 | 4 | 4 ● | 2012 | 14-50 | 122 | 52 | - | 32 | 92 | 20,0 | - | 9,2 | 1,8 | GG-30 |
| 61.0118.05 | 118 | 5 | 4 ● | 2012 | 14-50 | 122 | 64 | - | 32 | 92 | 32,0 | - | 9,2 | 1,8 | GG-25 |
| 61.0118.06 | 118 | 6 | 3 ● | 2517 | 16-60 | 122 | 76 | - | 45 | 92 | - | 31,0 | 10,2 | 2,0 | GG-25 |
| 61.0125.01 | 125 | 1 | 2 ○ | 1610 | 14-42 | 129 | 16 | 85 | 25 | - | 9,0 | - | 5,1 | 1,0 | GG-25 |
| 61.0125.02 | 125 | 2 | 5 ○ | 1610 | 14-42 | 129 | 28 | 85 | 25 | - | 3,0 | - | 7,1 | 1,4 | GG-25 |
| 61.0125.03 | 125 | 3 | 4 ● | 2012 | 14-50 | 129 | 40 | - | 32 | 99 | 8,0 | - | 9,2 | 1,8 | GG-25 |
| 61.0125.04 | 125 | 4 | 4 ● | 2012 | 14-50 | 129 | 52 | - | 32 | 99 | 20,0 | - | 11,2 | 2,2 | GG-25 |
| 61.0125.05 | 125 | 5 | 4 ● | 2012 | 14-50 | 129 | 64 | - | 32 | 99 | 32,0 | - | 11,7 | 2,3 | GG-25 |
| 61.0125.06 | 125 | 6 | 4 ● | 2517 | 16-60 | 129 | 76 | - | 45 | 99 | 31,0 | - | 12,7 | 2,5 | GG-25 |
| 61.0132.01 | 132 | 1 | 2 ○ | 1610 | 14-42 | 136 | 16 | 85 | 25 | - | 9,0 | - | 5,6 | 1,1 | GG-25 |
| 61.0132.02 | 132 | 2 | 5 ○ | 1610 | 14-42 | 136 | 28 | 85 | 25 | - | 3,0 | - | 7,6 | 1,5 | GG-25 |
| 61.0132.03 | 132 | 3 | 4 ● | 2012 | 14-50 | 136 | 40 | - | 32 | 106 | 8,0 | - | 11,7 | 2,3 | GG-25 |
| 61.0132.04 | 132 | 4 | 4 ● | 2012 | 14-50 | 136 | 52 | - | 32 | 106 | 20,0 | - | 12,7 | 2,5 | GG-25 |
| 61.0132.05 | 132 | 5 | 4 ● | 2517 | 16-60 | 136 | 64 | - | 45 | 106 | 19,0 | - | 13,8 | 2,7 | GG-25 |
| 61.0132.06 | 132 | 6 | 4 ● | 2517 | 16-60 | 136 | 76 | - | 45 | 106 | 31,0 | - | 14,8 | 2,9 | GG-25 |
| 61.0140.01 | 140 | 1 | 2 ○ | 1610 | 14-42 | 144 | 16 | 85 | 25 | - | 9,0 | - | 6,1 | 1,2 | GG-25 |
| 61.0140.02 | 140 | 2 | 5 ○ | 1610 | 14-42 | 144 | 28 | 85 | 25 | - | 3,0 | - | 8,7 | 1,7 | GG-25 |
| 61.0140.03 | 140 | 3 | 4 ● | 2012 | 14-50 | 144 | 40 | - | 32 | 114 | 8,0 | - | 13,2 | 2,6 | GG-25 |
| 61.0140.04 | 140 | 4 | 4 ● | 2012 | 14-50 | 144 | 52 | - | 32 | 114 | 20,0 | - | 14,8 | 2,9 | GG-25 |
| 61.0140.05 | 140 | 5 | 4 ● | 2517 | 16-60 | 144 | 64 | - | 45 | 114 | 19,0 | - | 16,3 | 3,2 | GG-25 |
| 61.0140.06 | 140 | 6 | 4 ● | 2517 | 16-60 | 144 | 76 | - | 45 | 114 | 31,0 | - | 17,8 | 3,5 | GG-25 |
| 61.0140.08 | 140 | 8 | 7 ● | 2517 | 16-60 | 144 | 100 | - | 45 | 114 | 27,5 | 27,5 | 20,9 | 4,1 | GG-25 |
| 61.0150.01 | 150 | 1 | 2 ○ | 1610 | 14-42 | 154 | 16 | 85 | 25 | - | 9,0 | - | 6,1 | 1,2 | GG-25 |
| 61.0150.02 | 150 | 2 | 2 ○ | 2012 | 14-50 | 154 | 28 | 95 | 32 | - | 4,0 | - | 10,2 | 2,0 | GG-25 |
| 61.0150.03 | 150 | 3 | 4 ● | 2012 | 14-50 | 154 | 40 | - | 32 | 124 | 8,0 | - | 15,8 | 3,1 | GG-25 |
| 61.0150.04 | 150 | 4 | 4 ● | 2517 | 16-60 | 154 | 52 | - | 45 | 124 | 7,0 | - | 18,9 | 3,7 | GG-25 |
| 61.0150.05 | 150 | 5 | 4 ● | 2517 | 16-60 | 154 | 64 | - | 45 | 124 | 19,0 | - | 20,4 | 4,0 | GG-25 |
| 61.0150.06 | 150 | 6 | 4 ● | 2517 | 16-60 | 154 | 76 | - | 45 | 124 | 31,0 | - | 22,4 | 4,4 | GG-25 |
| 61.0150.08 | 150 | 8 | 7 ● | 2517 | 16-60 | 154 | 100 | - | 45 | 124 | 27,5 | 27,5 | 25,5 | 5,0 | GG-25 |
| 61.0160.01 | 160 | 1 | 2 ○ | 1610 | 14-42 | 164 | 16 | 85 | 25 | - | 9,0 | - | 6,6 | 1,3 | GG-25 |
| 61.0160.02 | 160 | 2 | 2 ○ | 2012 | 14-50 | 164 | 28 | 105 | 32 | - | 4,0 | - | 12,7 | 2,5 | GG-25 |
| 61.0160.03 | 160 | 3 | 5 ○ | 2012 | 14-50 | 164 | 40 | 105 | 32 | 134 | 8,0 | - | 18,3 | 3,6 | GG-25 |
| 61.0160.04 | 160 | 4 | 4 ● | 2517 | 16-60 | 164 | 52 | - | 45 | 134 | 7,0 | - | 22,4 | 4,4 | GG-25 |
| 61.0160.05 | 160 | 5 | 4 ● | 2517 | 16-60 | 164 | 64 | - | 45 | 134 | 19,0 | - | 24,5 | 4,8 | GG-25 |
| 61.0160.06 | 160 | 6 | 4 ● | 2517 | 16-60 | 164 | 76 | - | 45 | 134 | 31,0 | - | 26,5 | 5,2 | GG-25 |
| 61.0160.08 | 160 | 8 | 7 ● | 2517 | 16-60 | 164 | 100 | - | 45 | 134 | 27,5 | 27,5 | 29,0 | 5,7 | GG-25 |
| 51.0170.01 | 170 | 1 | 2 ▲ | 1610 | 14-42 | 174 | 16 | 66 | 25 | 146 | 9 | - | 5,1 | 1,0 | GGG-60 |
| 51.0170.02 | 170 | 2 | 2 ▲ | 2012 | 14-50 | 174 | 28 | 84 | 32 | 146 | 4 | - | 6,6 | 1,3 | GGG-60 |
| 51.0170.03 | 170 | 3 | 5 ▲ | 2012 | 14-50 | 174 | 40 | 84 | 32 | 146 | 8 | - | 8,7 | 1,6 | GGG-60 |

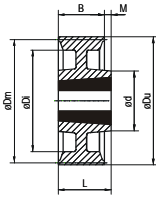

Type 2

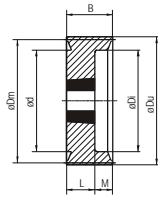

Type 4

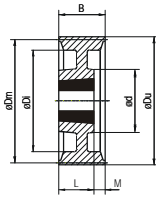

Type 5

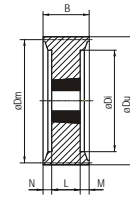

Type 7

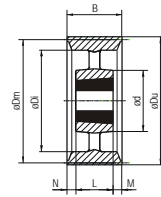

Type 8

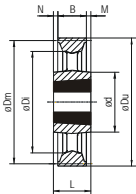

Type 9

| Code | Dm | Grooves Spor | Pulley Skive | Bush Bøsn. | Bore Udboring | Du | B | d | L | Di | M | N | Unbalance Ubalance | Weight Vægt | Matr. |
|------------|-----|-----------------|-----------------|---------------|------------------|-----|-----|-------|----|-----|------|------|-----------------------|----------------|------------|
| EDB | mm | no./antal | type | type | mm | mm | mm | mm | mm | mm | mm | mm | gcm (max) | kg | DIN1691/93 |
| 51.0180.01 | 180 | 1 | 2 ▲ | 1610 | 14-42 | 184 | 16 | 74 | 25 | 151 | 9,0 | - | 4,9 | 1,1 | GGG 60 |
| 51.0180.02 | 180 | 2 | 2 ▲ | 2012 | 14-50 | 184 | 28 | 84 | 32 | 151 | 4,0 | - | 7,6 | 1,5 | GGG 60 |
| 51.0180.03 | 180 | 3 | 5 ▲ | 2012 | 14-50 | 184 | 40 | 84 | 32 | 154 | 8,0 | - | 14,7 | 1,7 | GGG 60 |
| 51.0180.04 | 180 | 4 | 5 ▲ | 2517 | 16-60 | 184 | 52 | 102 | 45 | 154 | 7,0 | - | 18,6 | 2,5 | GGG 60 |
| 51.0180.05 | 180 | 5 | 5 ▲ | 2517 | 16-60 | 184 | 64 | 102 | 45 | 154 | 19,0 | - | 19,3 | 2,8 | GGG 60 |
| 51.0180.06 | 180 | 6 | 5 ▲ | 2517 | 16-60 | 184 | 76 | 102 | 45 | 154 | 31,0 | - | 20,8 | 3,2 | GGG 60 |
| 61.0180.08 | 180 | 8 | 7 ● | 3020 | 25-75 | 184 | 100 | - | 51 | 154 | 24,5 | 24,5 | 35,2 | 6,9 | GG-25 |
| 51.0190.01 | 190 | 1 | 2 ▲ | 2012 | 14-50 | 194 | 16 | 84 | 32 | 166 | 9 | - | 6,1 | 1,2 | GGG-60 |
| 51.0190.02 | 190 | 2 | 2 ▲ | 2012 | 14-50 | 194 | 28 | 84 | 32 | 166 | 4 | - | 7,1 | 1,5 | GGG-60 |
| 51.0190.03 | 190 | 3 | 5 ▲ | 2012 | 14-50 | 194 | 40 | 84 | 32 | 166 | 8 | - | 9,2 | 1,9 | GGG-60 |
| 51.0200.01 | 200 | 1 | 2 ▲ | 2012 | 14-50 | 204 | 16 | 84 | 32 | 171 | 16,0 | - | 7,4 | 1,3 | GGG 60 |
| 51.0200.02 | 200 | 2 | 2 ▲ | 2012 | 14-50 | 204 | 28 | 84 | 32 | 171 | 4,0 | - | 9,0 | 1,6 | GGG 60 |
| 51.0200.03 | 200 | 3 | 5 ▲ | 2012 | 14-50 | 204 | 40 | 84 | 32 | 177 | 8,0 | - | 10,1 | 1,9 | GGG 60 |
| 51.0200.04 | 200 | 4 | 8 ▲ | 2517 | 16-60 | 204 | 52 | 102 | 45 | 177 | 3,5 | 3,5 | 14,4 | 2,7 | GGG 60 |
| 51.0200.05 | 200 | 5 | 8 ▲ | 2517 | 16-60 | 204 | 64 | 102 | 45 | 177 | 9,5 | 9,5 | 16,0 | 3,0 | GGG 60 |
| 51.0200.06 | 200 | 6 | 8 ▲ | 2517 | 16-60 | 204 | 76 | 102 | 45 | 177 | 15,5 | 15,5 | 17,6 | 3,3 | GGG 60 |
| 51.0200.08 | 200 | 8 | 8 ▲ | 3020 | 25-75 | 204 | 100 | 125,5 | 51 | 177 | 24,5 | 24,5 | 25,1 | 4,7 | GGG 60 |
| 51.0224.01 | 224 | 1 | 9 ▲ | 2012 | 14-50 | 228 | 16 | 84 | 32 | 199 | 8,0 | 8,0 | 9,0 | 1,3 | GGG 60 |
| 51.0224.02 | 224 | 2 | 9 ▲ | 2012 | 14-50 | 228 | 28 | 84 | 32 | 199 | 2,0 | 2,0 | 11,5 | 1,7 | GGG 60 |
| 51.0224.03 | 224 | 3 | 5 ▲ | 2012 | 14-50 | 228 | 40 | 84 | 32 | 200 | 8,0 | - | 14,9 | 2,0 | GGG 60 |
| 51.0224.04 | 224 | 4 | 8 ▲ | 2517 | 16-60 | 228 | 52 | 102 | 45 | 200 | 3,5 | 3,5 | 17,3 | 2,9 | GGG 60 |
| 51.0224.05 | 224 | 5 | 8 ▲ | 2517 | 16-60 | 228 | 64 | 102 | 45 | 200 | 9,5 | 9,5 | 19,7 | 3,3 | GGG 60 |
| 51.0224.06 | 224 | 6 | 8 ▲ | 2517 | 16-60 | 228 | 76 | 102 | 45 | 200 | 15,5 | 15,5 | 21,5 | 3,6 | GGG 60 |
| 51.0224.08 | 224 | 8 | 8 ▲ | 3020 | 25-75 | 228 | 100 | 125,5 | 51 | 200 | 24,5 | 24,5 | 29,3 | 4,9 | GGG 60 |
| 51.0250.01 | 250 | 1 | 9 ▲ | 2012 | 14-50 | 254 | 16 | 84 | 32 | 224 | 8,0 | 8,0 | 11,2 | 1,5 | GGG 60 |
| 51.0250.02 | 250 | 2 | 9 ▲ | 2012 | 14-50 | 254 | 28 | 84 | 32 | 224 | 2,0 | 2,0 | 14,0 | 1,9 | GGG 60 |
| 51.0250.03 | 250 | 3 | 8 ▲ | 2012 | 14-50 | 254 | 40 | 84 | 32 | 228 | 4,0 | 4,0 | 14,7 | 2,2 | GGG 60 |
| 51.0250.04 | 250 | 4 | 8 ▲ | 2517 | 16-60 | 254 | 52 | 102 | 45 | 228 | 3,5 | 3,5 | 20,7 | 3,1 | GGG 60 |
| 51.0250.05 | 250 | 5 | 8 ▲ | 2517 | 16-60 | 254 | 64 | 102 | 45 | 228 | 9,5 | 9,5 | 24,0 | 3,6 | GGG 60 |
| 51.0250.06 | 250 | 6 | 8 ▲ | 2517 | 16-60 | 254 | 76 | 102 | 45 | 228 | 15,5 | 15,5 | 27,3 | 4,1 | GGG 60 |
| 51.0250.08 | 250 | 8 | 8 ▲ | 3020 | 25-75 | 254 | 100 | 125,5 | 51 | 224 | 24,5 | 24,5 | 36,7 | 5,5 | GGG 60 |
| 51.0280.01 | 280 | 1 | 9 ▲ | 2012 | 14-50 | 284 | 16 | 84 | 32 | 254 | 8,0 | 8,0 | 13,0 | 1,8 | GGG 60 |
| 51.0280.02 | 280 | 2 | 9 ▲ | 2012 | 14-50 | 284 | 28 | 84 | 32 | 254 | 2,0 | 2,0 | 17,9 | 2,2 | GGG 60 |
| 51.0280.03 | 280 | 3 | 9 ▲ | 2517 | 16-60 | 284 | 40 | 102 | 45 | 256 | 2,5 | 2,5 | 22,4 | 3,0 | GGG 60 |
| 51.0280.04 | 280 | 4 | 8 ▲ | 2517 | 16-60 | 284 | 52 | 102 | 45 | 256 | 3,5 | 3,5 | 25,4 | 3,4 | GGG 60 |
| 51.0280.05 | 280 | 5 | 8 ▲ | 2517 | 16-60 | 284 | 64 | 102 | 45 | 256 | 9,5 | 9,5 | 31,4 | 4,2 | GGG 60 |
| 51.0280.06 | 280 | 6 | 8 ▲ | 2517 | 16-60 | 284 | 76 | 102 | 45 | 256 | 15,5 | 15,5 | 35,1 | 4,7 | GGG 60 |
| 51.0280.08 | 280 | 8 | 8 ▲ | 3020 | 25-75 | 284 | 100 | 125,5 | 51 | 254 | 24,5 | 24,5 | 48,4 | 5,9 | GGG 60 |
| 51.0315.01 | 315 | 1 | 9 ▲ | 2012 | 14-50 | 319 | 16 | 84 | 32 | 289 | 8,0 | 8,0 | 15,6 | 2,2 | GGG 60 |
| 51.0315.02 | 315 | 2 | 9 ▲ | 2012 | 14-50 | 319 | 28 | 84 | 32 | 289 | 2,0 | 2,0 | 21,2 | 2,8 | GGG 60 |
| 51.0315.03 | 315 | 3 | 9 ▲ | 2517 | 16-60 | 319 | 40 | 102 | 45 | 291 | 2,5 | 2,5 | 51,2 | 3,3 | GGG 60 |
| 51.0315.04 | 315 | 4 | 8 ▲ | 2517 | 16-60 | 319 | 52 | 102 | 45 | 291 | 3,5 | 3,5 | 34,4 | 4,1 | GGG 60 |
| 51.0315.05 | 315 | 5 | 8 ▲ | 2517 | 16-60 | 319 | 64 | 102 | 45 | 291 | 9,5 | 9,5 | 37,8 | 4,5 | GGG 60 |
| 51.0315.06 | 315 | 6 | 8 ▲ | 2517 | 16-60 | 319 | 76 | 102 | 45 | 291 | 15,5 | 15,5 | 45,4 | 5,4 | GGG 60 |
| 51.0315.08 | 315 | 8 | 8 ▲ | 3020 | 25-75 | 319 | 100 | 125,5 | 51 | 291 | 24,5 | 24,5 | 60,5 | 7,2 | GGG 60 |
| 51.0355.01 | 355 | 1 | 9 ▲ | 2012 | 14-50 | 359 | 16 | 84 | 32 | 329 | 8,0 | 8,0 | 19,9 | 2,9 | GGG 60 |
| 51.0355.02 | 355 | 2 | 9 ▲ | 2012 | 14-50 | 359 | 28 | 84 | 32 | 329 | 2,0 | 2,0 | 29,0 | 3,2 | GGG 60 |
| 51.0355.03 | 355 | 3 | 9 ▲ | 2517 | 16-60 | 359 | 40 | 102 | 45 | 329 | 2,5 | 2,5 | 36,0 | 3,8 | GGG 60 |
| 51.0355.04 | 355 | 4 | 8 ▲ | 2517 | 16-60 | 359 | 52 | 102 | 45 | 329 | 3,5 | 3,5 | 42,6 | 4,5 | GGG 60 |
| 51.0355.05 | 355 | 5 | 8 ▲ | 2517 | 16-60 | 359 | 64 | 102 | 45 | 329 | 9,5 | 9,5 | 48,3 | 5,1 | GGG 60 |
| 51.0355.06 | 355 | 6 | 8 ▲ | 2517 | 16-60 | 359 | 76 | 102 | 45 | 329 | 15,5 | 15,5 | 54,9 | 5,8 | GGG 60 |
| 51.0355.08 | 355 | 8 | 8 ▲ | 3020 | 35-75 | 359 | 100 | 125,5 | 51 | 329 | 24,5 | 24,5 | 74,8 | 7,9 | GGG 60 |

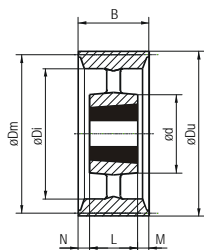

Type 8

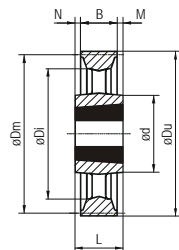

Type 9

| Code | Dm | Grooves Spor | Pulley Skive | Bush Bøsn. | Bore Udboring | Du | B | d | L | Di | M | N | Unbalance Ubalance | Weight Vægt | Matr. |
|------------|-----|-----------------|-----------------|---------------|------------------|-----|-----|-------|----|-----|------|------|-----------------------|----------------|------------|
| EDB | mm | no./antal | type | type | mm | mm | mm | mm | mm | mm | mm | mm | gcm (max) | kg | DIN1691/93 |
| 51.0400.01 | 400 | 1 | 9 ▲ | 2012 | 14-50 | 404 | 16 | 84 | 32 | 374 | 8,0 | 8,0 | 26,9 | 3,2 | GGG 60 |
| 51.0400.02 | 400 | 2 | 9 ▲ | 2517 | 16-60 | 404 | 28 | 102 | 45 | 374 | 8,5 | 8,5 | 40,3 | 4,0 | GGG 60 |
| 51.0400.03 | 400 | 3 | 9 ▲ | 2517 | 16-60 | 404 | 40 | 102 | 45 | 376 | 2,5 | 2,5 | 43,7 | 4,1 | GGG 60 |
| 51.0400.04 | 400 | 4 | 8 ▲ | 2517 | 16-60 | 404 | 52 | 102 | 45 | 376 | 3,5 | 3,5 | 54,4 | 5,1 | GGG 60 |
| 51.0400.05 | 400 | 5 | 8 ▲ | 3020 | 25-75 | 404 | 64 | 125,5 | 51 | 376 | 6,5 | 6,5 | 69,3 | 6,5 | GGG 60 |
| 51.0400.06 | 400 | 6 | 8 ▲ | 3020 | 25-75 | 404 | 76 | 125,5 | 51 | 376 | 12,5 | 12,5 | 83,2 | 7,1 | GGG 60 |
| 51.0400.08 | 400 | 8 | 8 ▲ | 3020 | 35-75 | 404 | 100 | 125,5 | 51 | 376 | 24,5 | 24,5 | 96,0 | 9,0 | GGG 60 |
| 51.0450.01 | 450 | 1 | 9 ▲ | 2517 | 16-60 | 454 | 16 | 102 | 45 | 424 | 14,5 | 14,5 | 43,2 | 5,8 | GGG 60 |
| 51.0450.02 | 450 | 2 | 9 ▲ | 2517 | 16-60 | 454 | 28 | 102 | 45 | 423 | 8,5 | 8,5 | 67,8 | 6,6 | GGG 60 |
| 51.0450.03 | 450 | 3 | 9 ▲ | 2517 | 16-60 | 454 | 40 | 102 | 45 | 424 | 2,5 | 2,5 | 63,6 | 5,3 | GGG 60 |
| 51.0450.04 | 450 | 4 | 8 ▲ | 3020 | 25-75 | 454 | 52 | 125,5 | 51 | 424 | 0,5 | 0,5 | 88,8 | 7,6 | GGG 60 |
| 51.0450.05 | 450 | 5 | 8 ▲ | 3020 | 25-75 | 454 | 64 | 125,5 | 51 | 424 | 6,5 | 6,5 | 100,8 | 8,4 | GGG 60 |
| 51.0450.06 | 450 | 6 | 8 ▲ | 3020 | 25-75 | 454 | 76 | 125,5 | 51 | 424 | 12,5 | 12,5 | 112,8 | 9,4 | GGG 60 |
| 51.0450.08 | 450 | 8 | 8 ▲ | 3525 | 35-100 | 454 | 100 | 150 | 65 | 424 | 17,5 | 17,5 | 159,6 | 13,3 | GGG 60 |
| 51.0500.01 | 500 | 1 | 9 ▲ | 2517 | 16-60 | 504 | 16 | 102 | 45 | 474 | 14,5 | 14,5 | 52,8 | 6,3 | GGG 60 |
| 51.0500.02 | 500 | 2 | 9 ▲ | 2517 | 16-60 | 504 | 28 | 102 | 45 | 473 | 8,5 | 8,5 | 82,0 | 7,3 | GGG 60 |
| 51.0500.03 | 500 | 3 | 9 ▲ | 2517 | 16-60 | 504 | 40 | 102 | 45 | 476 | 2,5 | 2,5 | 93,3 | 7,0 | GGG 60 |
| 51.0500.04 | 500 | 4 | 8 ▲ | 3020 | 25-75 | 504 | 52 | 125,5 | 51 | 476 | 0,5 | 0,5 | 112,0 | 8,4 | GGG 60 |
| 51.0500.05 | 500 | 5 | 8 ▲ | 3020 | 25-75 | 504 | 64 | 125,5 | 51 | 476 | 6,5 | 6,5 | 133,3 | 10,0 | GGG 60 |
| 51.0500.06 | 500 | 6 | 8 ▲ | 3020 | 25-75 | 504 | 76 | 125,5 | 51 | 476 | 12,5 | 12,5 | 149,3 | 11,2 | GGG 60 |
| 51.0500.08 | 500 | 8 | 8 ▲ | 3525 | 35-100 | 504 | 100 | 150 | 89 | 476 | 17,5 | 17,5 | 204,0 | 15,3 | GGG 60 |
| 51.0630.02 | 630 | 2 | 9 ▲ | 2517 | 16-60 | 634 | 28 | 102 | 45 | 604 | 8,5 | 8,5 | 116,9 | 10,7 | GGG 60 |
| 51.0630.03 | 630 | 3 | 9 ▲ | 2517 | 16-60 | 634 | 40 | 102 | 45 | 604 | 2,5 | 2,5 | 160,3 | 11,2 | GGG 60 |
| 51.0630.04 | 630 | 4 | 8 ▲ | 3020 | 25-75 | 634 | 52 | 125,5 | 51 | 604 | 0,5 | 0,5 | 184,5 | 13,9 | GGG 60 |
| 51.0630.05 | 630 | 5 | 8 ▲ | 3020 | 25-75 | 634 | 64 | 125,5 | 51 | 604 | 6,5 | 6,5 | 211,7 | 14,1 | GGG 60 |
| 51.0630.06 | 630 | 6 | 8 ▲ | 3525 | 35-100 | 634 | 76 | 150 | 65 | 604 | 5,5 | 5,5 | 261,1 | 15,5 | GGG 60 |
| 51.0630.08 | 630 | 8 | 8 ▲ | 3525 | 35-100 | 634 | 100 | 150 | 65 | 604 | 17,5 | 17,5 | 361,9 | 21,5 | GGG 60 |
| 51.0710.03 | 710 | 3 | 9 ▲ | 3020 | 25-75 | 714 | 40 | 125,5 | 51 | 684 | 5,5 | 5,5 | 214,7 | 11,3 | GGG 60 |
| 51.0710.04 | 710 | 4 | 8 ▲ | 3020 | 25-75 | 714 | 52 | 125,5 | 51 | 684 | 0,5 | 0,5 | 277,2 | 19,6 | GGG 60 |
| 51.0710.05 | 710 | 5 | 9 ▲ | 3525 | 35-100 | 714 | 64 | 150 | 65 | 684 | 24,5 | 24,5 | 355,6 | 21,4 | GGG 60 |
| 51.0710.06 | 710 | 6 | 8 ▲ | 3525 | 35-100 | 714 | 76 | 150 | 65 | 684 | 5,5 | 5,5 | 388,5 | 22,7 | GGG 60 |
| 51.0710.08 | 710 | 8 | 8 ▲ | 3525 | 35-100 | 714 | 100 | 150 | 65 | 684 | 17,5 | 17,5 | 478,3 | 24,9 | GGG 60 |
| 51.0800.03 | 800 | 3 | 9 ▲ | 3020 | 25-75 | 804 | 40 | 125,5 | 51 | 774 | 5,5 | 5,5 | 267,5 | 12,5 | GGG 60 |
| 51.0800.04 | 800 | 4 | 8 ▲ | 3020 | 25-75 | 804 | 52 | 125,5 | 51 | 774 | 0,5 | 0,5 | 363,5 | 17,0 | GGG 60 |
| 51.0800.05 | 800 | 5 | 9 ▲ | 3525 | 35-100 | 804 | 64 | 150 | 65 | 774 | 24,5 | 24,5 | 423,7 | 22,7 | GGG 60 |
| 51.0800.06 | 800 | 6 | 9 ▲ | 3525 | 35-100 | 804 | 76 | 150 | 65 | 774 | 5,5 | 5,5 | 519,7 | 24,4 | GGG 60 |
| 51.0800.08 | 800 | 8 | 8 ▲ | 3525 | 35-100 | 804 | 100 | 150 | 65 | 774 | 17,5 | 17,5 | 558,1 | 28,3 | GGG 60 |

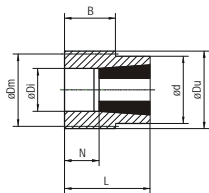

Type 0

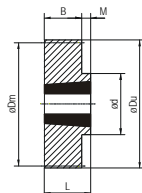

Type 1

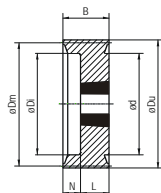

Type 3

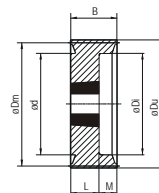

Type 4

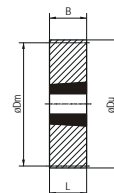

Type 6

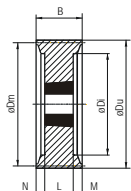

Type 7

| Code | Dm | Grooves Spor | Pulley Skive | Bush Bøsn. | Bore Udboring | Du | B | d | L | Di | M | N | Unbalance Ubalance | Weight Vægt | Matr. |
|------------|-----|-----------------|-----------------|---------------|------------------|-------|----|------|----|----|------|------|-----------------------|----------------|------------|
| EDB | mm | no./antal | type | type | mm | mm | mm | mm | mm | mm | mm | mm | gcm (max) | kg | DIN1691/93 |
| 62.0063.01 | 63 | 1 | 0 ● | 1108 | 9-28 | 68,5 | 20 | 68,5 | 40 | 31 | - | 18,0 | 3,1 | 0,6 | GG-25 |
| 62.0063.02 | 63 | 2 | 0 ● | 1108 | 9-28 | 68,5 | 35 | 68,5 | 55 | 31 | - | 33,0 | 4,1 | 0,8 | GG-25 |
| 62.0067.01 | 67 | 1 | 1 ● | 1108 | 9-28 | 72,5 | 20 | 60 | 22 | - | 2,0 | - | 1,5 | 0,3 | GG-25 |
| 62.0067.02 | 67 | 2 | 3 ● | 1108 | 9-28 | 72,5 | 35 | - | 22 | 35 | - | 13,0 | 2,5 | 0,5 | GG-25 |
| 62.0071.01 | 71 | 1 | 1 ● | 1108 | 9-28 | 76,5 | 20 | 60 | 22 | - | 2,0 | - | 1,5 | 0,3 | GG-25 |
| 62.0071.02 | 71 | 2 | 3 ● | 1108 | 9-28 | 76,5 | 35 | - | 22 | 39 | - | 13,0 | 2,5 | 0,5 | GG-25 |
| 62.0071.03 | 71 | 3 | 3 ● | 1108 | 9-28 | 76,5 | 50 | - | 22 | 39 | - | 28,0 | 3,6 | 0,7 | GG-25 |
| 62.0075.01 | 75 | 1 | 1 ● | 1108 | 9-28 | 80,5 | 20 | 60 | 22 | - | 2,0 | - | 2,0 | 0,4 | GG-25 |
| 62.0075.02 | 75 | 2 | 3 ● | 1108 | 9-28 | 80,5 | 35 | - | 22 | 43 | - | 13,0 | 3,1 | 0,6 | GG-25 |
| 62.0075.03 | 75 | 3 | 3 ● | 1108 | 9-28 | 80,5 | 50 | - | 22 | 43 | - | 28,0 | 4,1 | 0,8 | GG-25 |
| 62.0080.01 | 80 | 1 | 1 ● | 1210 | 11-32 | 85,5 | 20 | 80 | 25 | - | 5,0 | - | 2,5 | 0,5 | GG-30 |
| 62.0080.02 | 80 | 2 | 6 ● | 1210 | 11-32 | 85,5 | 35 | - | 35 | - | - | - | 3,1 | 0,6 | GG-30 |
| 62.0080.03 | 80 | 3 | 3 ● | 1210 | 11-32 | 85,5 | 50 | - | 25 | 48 | - | 25,0 | 4,6 | 0,9 | GG-30 |
| 62.0085.01 | 85 | 1 | 1 ● | 1210 | 11-32 | 90,5 | 20 | 80 | 25 | - | 5,0 | - | 3,1 | 0,6 | GG-30 |
| 62.0085.02 | 85 | 2 | 6 ● | 1210 | 11-32 | 90,5 | 35 | - | 35 | - | - | - | 3,6 | 0,7 | GG-30 |
| 62.0085.03 | 85 | 3 | 3 ● | 1210 | 11-32 | 90,5 | 50 | - | 25 | 53 | - | 25,0 | 5,1 | 1,0 | GG-30 |
| 62.0090.01 | 90 | 1 | 1 ● | 1210 | 11-32 | 95,5 | 20 | 80 | 25 | - | 5,0 | - | 3,6 | 0,7 | GG-30 |
| 62.0090.02 | 90 | 2 | 6 ● | 1610 | 14-42 | 95,5 | 35 | - | 35 | - | - | - | 3,6 | 0,7 | GG-30 |
| 62.0090.03 | 90 | 3 | 3 ● | 1610 | 14-42 | 95,5 | 50 | - | 25 | 58 | - | 25,0 | 5,1 | 1,0 | GG-30 |
| 62.0090.04 | 90 | 4 | 3 ● | 1610 | 14-42 | 95,5 | 65 | - | 25 | 58 | - | 40,0 | 5,6 | 1,1 | GG-30 |
| 62.0095.01 | 95 | 1 | 1 ● | 1210 | 11-32 | 100,5 | 20 | 80 | 25 | - | 5,0 | - | 4,1 | 0,8 | GG-30 |
| 62.0095.02 | 95 | 2 | 6 ● | 1610 | 14-42 | 100,5 | 35 | - | 35 | - | - | - | 4,6 | 0,9 | GG-30 |
| 62.0095.03 | 95 | 3 | 3 ● | 1610 | 14-42 | 100,5 | 50 | - | 25 | 63 | - | 25,0 | 5,6 | 1,1 | GG-30 |
| 62.0095.04 | 95 | 4 | 3 ● | 1610 | 14-42 | 100,5 | 65 | - | 25 | 63 | - | 40,0 | 6,1 | 1,2 | GG-30 |
| 62.0100.01 | 100 | 1 | 1 ● | 1610 | 14-42 | 105,5 | 20 | 85 | 25 | - | 5,0 | - | 4,1 | 0,8 | GG-25 |
| 62.0100.02 | 100 | 2 | 3 ● | 1610 | 14-42 | 105,5 | 35 | - | 25 | 68 | - | 10,0 | 4,6 | 0,9 | GG-25 |
| 62.0100.03 | 100 | 3 | 4 ● | 1610 | 14-42 | 105,5 | 50 | - | 25 | 68 | 25,0 | - | 6,1 | 1,2 | GG-25 |
| 62.0100.04 | 100 | 4 | 4 ● | 1610 | 14-42 | 105,5 | 65 | - | 25 | 68 | 40,0 | - | 7,6 | 1,5 | GG-25 |
| 62.0100.05 | 100 | 5 | 7 ● | 1610 | 14-42 | 105,5 | 80 | - | 25 | 68 | 42,0 | 13,0 | 8,7 | 1,7 | GG-25 |
| 62.0100.06 | 100 | 6 | 7 ● | 1610 | 14-42 | 105,5 | 95 | - | 25 | 68 | 40,0 | 30,0 | 13,2 | 2,6 | GG-25 |
| 62.0106.01 | 106 | 1 | 1 ● | 1610 | 14-42 | 111,5 | 20 | 85 | 25 | - | 5,0 | - | 4,6 | 0,9 | GG-25 |
| 62.0106.02 | 106 | 2 | 3 ● | 1610 | 14-42 | 111,5 | 35 | - | 25 | 74 | - | 10,0 | 5,6 | 1,1 | GG-25 |
| 62.0106.03 | 106 | 3 | 4 ● | 1610 | 14-42 | 111,5 | 50 | - | 25 | 74 | 25,0 | - | 7,1 | 1,4 | GG-25 |
| 62.0106.04 | 106 | 4 | 3 ● | 2012 | 14-50 | 111,5 | 65 | - | 32 | 74 | - | 33,0 | 10,2 | 2,0 | GG-25 |
| 62.0106.05 | 106 | 5 | 3 ● | 2012 | 14-50 | 111,5 | 80 | - | 32 | 74 | - | 48,0 | 10,2 | 2,0 | GG-25 |
| 62.0106.06 | 106 | 6 | 3 ● | 2012 | 14-50 | 111,5 | 95 | - | 32 | 74 | - | 63,0 | 13,8 | 2,7 | GG-25 |
| 62.0112.01 | 112 | 1 | 1 ● | 1610 | 14-42 | 117,5 | 20 | 85 | 25 | - | 5,0 | - | 5,1 | 1,0 | GG-25 |
| 62.0112.02 | 112 | 2 | 3 ● | 1610 | 14-42 | 117,5 | 35 | - | 25 | 80 | - | 10,0 | 6,1 | 1,2 | GG-25 |
| 62.0112.03 | 112 | 3 | 3 ● | 2012 | 14-50 | 117,5 | 50 | - | 32 | 80 | - | 18,0 | 6,6 | 1,3 | GG-25 |
| 62.0112.04 | 112 | 4 | 3 ● | 2012 | 14-50 | 117,5 | 65 | - | 32 | 80 | - | 33,0 | 9,7 | 1,9 | GG-25 |
| 62.0112.05 | 112 | 5 | 3 ● | 2012 | 14-50 | 117,5 | 80 | - | 32 | 80 | - | 48,0 | 10,7 | 2,1 | GG-25 |
| 62.0112.06 | 112 | 6 | 3 ● | 2012 | 14-50 | 117,5 | 95 | - | 32 | 80 | - | 63,0 | 14,3 | 2,8 | GG-25 |

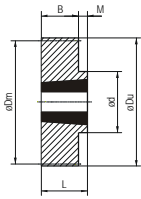

Type 1

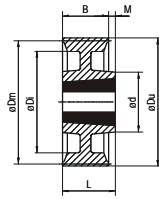

Type 2

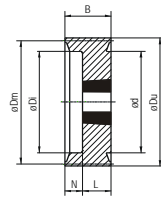

Type 3

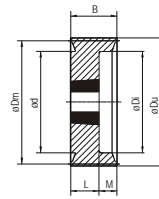

Type 4

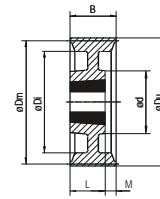

Type 5

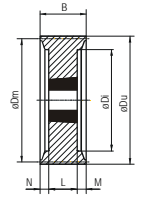

Type 7

| Code | Dm | Grooves Spor | Pulley Skive | Bush Bøsn. | Bore Udboring | Du | B | d | L | Di | M | N | Unbalance Ubalance | Weight Vægt | Matr. |
|------------|-----|--------------|--------------|------------|---------------|-------|----|-----|----|-----|------|------|--------------------|-------------|------------|
| EDB | mm | no./antal | type | type | mm | mm | mm | mm | mm | mm | mm | mm | gcm (max) | kg | DIN1691/93 |
| 62.0118.01 | 118 | 1 | 1 ● | 1610 | 14-42 | 123,5 | 20 | 85 | 25 | - | 5,0 | - | 6,1 | 1,2 | GG-25 |
| 62.0118.02 | 118 | 2 | 3 ● | 1610 | 14-42 | 123,5 | 35 | - | 25 | 86 | - | 10,0 | 7,1 | 1,4 | GG-25 |
| 62.0118.03 | 118 | 3 | 4 ● | 2012 | 14-50 | 123,5 | 50 | - | 32 | 86 | 18,0 | - | 9,2 | 1,8 | GG-25 |
| 62.0118.04 | 118 | 4 | 4 ● | 2012 | 14-50 | 123,5 | 65 | - | 32 | 86 | 33,0 | - | 10,2 | 2,0 | GG-25 |
| 62.0118.05 | 118 | 5 | 4 ● | 2012 | 14-50 | 123,5 | 80 | - | 32 | 86 | 48,0 | - | 12,2 | 2,4 | GG-25 |
| 62.0118.06 | 118 | 6 | 3 ● | 2012 | 14-50 | 123,5 | 95 | - | 32 | 84 | - | 63,0 | 16,3 | 3,2 | GG-25 |
| 62.0125.01 | 125 | 1 | 1 ● | 1610 | 14-42 | 130,5 | 20 | 85 | 25 | - | 5,0 | - | 7,1 | 1,4 | GG-20 |
| 62.0125.02 | 125 | 2 | 3 ● | 1610 | 14-42 | 130,5 | 35 | - | 25 | 93 | - | 10,0 | 8,7 | 1,7 | GG-25 |
| 62.0125.03 | 125 | 3 | 4 ● | 2012 | 14-50 | 130,5 | 50 | - | 32 | 93 | 18,0 | - | 10,2 | 2,0 | GG-25 |
| 62.0125.04 | 125 | 4 | 4 ● | 2012 | 14-50 | 130,5 | 65 | - | 32 | 93 | 33,0 | - | 12,7 | 2,5 | GG-25 |
| 62.0125.05 | 125 | 5 | 7 ● | 2012 | 14-50 | 130,5 | 80 | - | 32 | 93 | 24,0 | 24,0 | 13,8 | 2,7 | GG-25 |
| 62.0125.06 | 125 | 6 | 7 ● | 2012 | 14-50 | 130,5 | 95 | - | 32 | 90 | 31,5 | 31,5 | 18,3 | 3,6 | GG-25 |
| 62.0132.01 | 132 | 1 | 1 ● | 1610 | 14-42 | 137,5 | 20 | 85 | 25 | - | 5,0 | - | 8,2 | 1,6 | GG-25 |
| 62.0132.02 | 132 | 2 | 5 ○ | 2012 | 14-50 | 137,5 | 35 | 95 | 32 | - | 3,0 | - | 9,2 | 1,8 | GG-25 |
| 62.0132.03 | 132 | 3 | 4 ● | 2012 | 14-50 | 137,5 | 50 | - | 32 | 100 | 18,0 | - | 11,7 | 2,3 | GG-25 |
| 62.0132.04 | 132 | 4 | 4 ● | 2517 | 16-60 | 137,5 | 65 | - | 45 | 100 | 20,0 | - | 13,2 | 2,6 | GG-25 |
| 62.0132.05 | 132 | 5 | 7 ● | 2517 | 16-60 | 137,5 | 80 | - | 45 | 100 | 17,5 | 17,5 | 14,8 | 2,9 | GG-25 |
| 62.0132.06 | 132 | 6 | 7 ● | 2517 | 16-60 | 137,5 | 95 | - | 45 | 102 | 25,0 | 25,0 | 20,4 | 4,0 | GG-25 |
| 62.0140.01 | 140 | 1 | 1 ● | 1610 | 14-42 | 145,5 | 20 | 85 | 25 | - | 5,0 | - | 9,2 | 1,8 | GG-20 |
| 62.0140.02 | 140 | 2 | 5 ○ | 2012 | 14-50 | 145,5 | 35 | 95 | 32 | - | 3,0 | - | 10,2 | 2,0 | GG-25 |
| 62.0140.03 | 140 | 3 | 4 ● | 2517 | 16-60 | 145,5 | 50 | - | 45 | 108 | 5,0 | - | 14,3 | 2,8 | GG-25 |
| 62.0140.04 | 140 | 4 | 4 ● | 2517 | 16-60 | 145,5 | 65 | - | 45 | 108 | 20,0 | - | 15,8 | 3,1 | GG-25 |
| 62.0140.05 | 140 | 5 | 7 ● | 2517 | 16-60 | 145,5 | 80 | - | 45 | 108 | 17,5 | 17,5 | 17,3 | 3,4 | GG-25 |
| 62.0140.06 | 140 | 6 | 7 ● | 2517 | 16-60 | 145,5 | 95 | - | 45 | 105 | 25,0 | 25,0 | 23,9 | 4,7 | GG-25 |
| 62.0150.01 | 150 | 1 | 2 ○ | 1610 | 14-42 | 155,5 | 20 | 85 | 25 | - | 5,0 | - | 7,1 | 1,4 | GG-25 |
| 62.0150.02 | 150 | 2 | 5 ○ | 2012 | 14-50 | 155,5 | 35 | 95 | 32 | - | 3,0 | - | 12,2 | 2,4 | GG-25 |
| 62.0150.03 | 150 | 3 | 4 ● | 2517 | 16-60 | 155,5 | 50 | - | 45 | 118 | 5,0 | - | 17,8 | 3,5 | GG-25 |
| 62.0150.04 | 150 | 4 | 4 ● | 2517 | 16-60 | 155,5 | 65 | - | 45 | 118 | 20,0 | - | 19,4 | 3,8 | GG-25 |
| 62.0150.05 | 150 | 5 | 7 ● | 2517 | 16-60 | 155,5 | 80 | - | 45 | 118 | 17,5 | 17,5 | 21,4 | 4,2 | GG-25 |
| 62.0150.06 | 150 | 6 | 7 ● | 2517 | 16-60 | 155,5 | 95 | - | 45 | 115 | 25,0 | 25,0 | 28,5 | 5,6 | GG-25 |
| 62.0160.01 | 160 | 1 | 2 ○ | 1610 | 14-42 | 165,5 | 20 | 85 | 25 | - | 5,0 | - | 7,6 | 1,5 | GG-25 |
| 62.0160.02 | 160 | 2 | 5 ○ | 2012 | 14-50 | 165,5 | 35 | 105 | 32 | 128 | 3,0 | - | 11,7 | 2,3 | GG-25 |
| 62.0160.03 | 160 | 3 | 4 ● | 2517 | 16-60 | 165,5 | 50 | 120 | 45 | - | 5,0 | - | 19,9 | 3,9 | GG-25 |
| 62.0160.04 | 160 | 4 | 4 ● | 2517 | 16-60 | 165,5 | 65 | 120 | 45 | 128 | 20,0 | - | 22,4 | 4,4 | GG-25 |
| 62.0160.05 | 160 | 5 | 7 ● | 2517 | 16-60 | 165,5 | 80 | - | 45 | 128 | 17,5 | 17,5 | 26,0 | 5,1 | GG-25 |
| 62.0160.06 | 160 | 6 | 7 ● | 2517 | 16-60 | 165,5 | 95 | - | 45 | 125 | 25,0 | 25,0 | 30,6 | 6,0 | GG-25 |
| 52.0170.01 | 170 | 1 | 2 ▲ | 1610 | 14-42 | 175,5 | 20 | 66 | 25 | 144 | 5 | - | 5,6 | 1,0 | GGG-60 |
| 52.0170.02 | 170 | 2 | 5 ▲ | 2012 | 14-50 | 175,5 | 35 | 84 | 32 | 144 | 3 | - | 7,6 | 1,5 | GGG-60 |
| 52.0170.03 | 170 | 3 | 5 ▲ | 2517 | 16-60 | 175,5 | 50 | 102 | 45 | 144 | 5 | - | 12,2 | 2,4 | GGG-60 |
| 52.0180.01 | 180 | 1 | 2 ▲ | 1610 | 14-42 | 185,5 | 20 | 66 | 25 | 152 | 5,0 | - | 5,2 | 1,2 | GGG 60 |
| 52.0180.02 | 180 | 2 | 5 ▲ | 2012 | 14-50 | 185,5 | 35 | 84 | 32 | 152 | 3,0 | - | 10,4 | 1,8 | GGG 60 |
| 52.0180.03 | 180 | 3 | 5 ▲ | 2517 | 16-60 | 185,5 | 50 | 102 | 45 | 152 | 5,0 | - | 12,7 | 2,5 | GGG 60 |
| 52.0180.04 | 180 | 4 | 5 ▲ | 2517 | 16-60 | 185,5 | 65 | 102 | 45 | 152 | 20,0 | - | 15,3 | 3,0 | GGG 60 |
| 62.0180.05 | 180 | 5 | 7 ● | 3020 | 25-75 | 185,5 | 80 | - | 51 | 148 | 14,5 | 14,5 | 31,6 | 6,2 | GG-25 |
| 62.0180.06 | 180 | 6 | 7 ● | 3020 | 25-75 | 185,5 | 95 | - | 51 | 145 | 22,0 | 22,0 | 39,2 | 7,7 | GG-25 |
| 52.0190.01 | 190 | 1 | 2 ▲ | 1610 | 14-42 | 195,5 | 20 | 66 | 25 | 164 | 5 | - | 6,1 | 1,2 | GGG-60 |
| 52.0190.02 | 190 | 2 | 5 ▲ | 2012 | 14-50 | 195,5 | 35 | 84 | 32 | 164 | 3 | - | 8,2 | 1,7 | GGG-60 |
| 52.0190.03 | 190 | 3 | 5 ▲ | 2517 | 16-60 | 195,5 | 50 | 102 | 45 | 164 | 5 | - | 12,7 | 2,6 | GGG-60 |

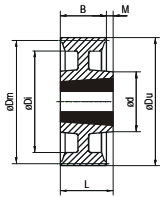

Type 2

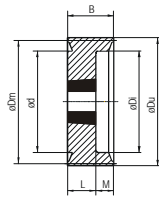

Type 4

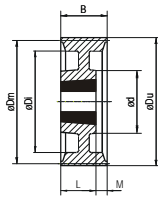

Type 5

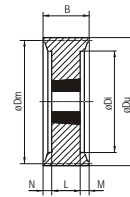

Type 7

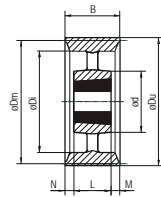

Type 8

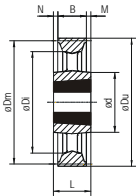

Type 9

| Code | Dm | Grooves Spor | Pulley Skive | Bush Bøsn. | Bore Udboring | Du | B | d | L | Di | M | N | Unbalance Ubalance | Weight Vægt | Matr. |
|------------|-----|--------------|--------------|------------|---------------|-------|----|-------|----|-----|------|------|--------------------|-------------|------------|
| EDB | mm | no./antal | type | type | mm | mm | mm | mm | mm | mm | mm | mm | gcm (max) | kg | DIN1691/93 |
| 52.0200.01 | 200 | 1 | 2 ▲ | 2012 | 14-50 | 205,5 | 20 | 84 | 32 | 168 | 12,0 | - | 8,3 | 1,6 | GGG 60 |
| 52.0200.02 | 200 | 2 | 2 ▲ | 2517 | 16-60 | 205,5 | 35 | 102 | 45 | 168 | 10,0 | - | 13,1 | 2,5 | GGG 60 |
| 52.0200.03 | 200 | 3 | 5 ▲ | 2517 | 16-60 | 205,5 | 50 | 102 | 45 | 172 | 5,0 | - | 14,4 | 2,7 | GGG 60 |
| 52.0200.04 | 200 | 4 | 5 ▲ | 3020 | 25-75 | 205,5 | 65 | 125,5 | 51 | 172 | 14,0 | - | 20,3 | 3,8 | GGG 60 |
| 52.0200.05 | 200 | 5 | 8 ▲ | 3020 | 25-75 | 205,5 | 80 | 125,5 | 51 | 172 | 14,5 | 14,5 | 21,9 | 4,1 | GGG 60 |
| 52.0200.06 | 200 | 6 | 8 ▲ | 3020 | 25-75 | 205,5 | 95 | 125,5 | 51 | 172 | 22,0 | 22,0 | 25,1 | 4,7 | GGG 60 |
| 52.0224.01 | 224 | 1 | 9 ▲ | 2012 | 14-50 | 229,5 | 20 | 84 | 32 | 193 | 6,0 | 6,0 | 9,7 | 1,8 | GGG 60 |
| 52.0224.02 | 224 | 2 | 9 ▲ | 2517 | 16-60 | 229,5 | 35 | 102 | 45 | 193 | 5,0 | 5,0 | 15,8 | 2,6 | GGG 60 |
| 52.0224.03 | 224 | 3 | 8 ▲ | 2517 | 16-60 | 229,5 | 50 | 102 | 45 | 198 | 2,5 | 2,5 | 17,9 | 3,0 | GGG 60 |
| 52.0224.04 | 224 | 4 | 8 ▲ | 3020 | 25-75 | 229,5 | 65 | 125,5 | 51 | 196 | 7,0 | 7,0 | 23,9 | 4,0 | GGG 60 |
| 52.0224.05 | 224 | 5 | 8 ▲ | 3020 | 25-75 | 229,5 | 80 | 125,5 | 51 | 196 | 14,5 | 14,5 | 26,9 | 4,5 | GGG 60 |
| 52.0224.06 | 224 | 6 | 8 ▲ | 3020 | 25-75 | 229,5 | 95 | 125,5 | 51 | 196 | 22,0 | 22,0 | 29,9 | 5,0 | GGG 60 |
| 52.0250.01 | 250 | 1 | 9 ▲ | 2012 | 14-50 | 255,5 | 20 | 84 | 32 | 218 | 6,0 | 6,0 | 11,6 | 1,9 | GGG 60 |
| 52.0250.02 | 250 | 2 | 9 ▲ | 2517 | 16-60 | 255,5 | 35 | 102 | 45 | 218 | 5,0 | 5,0 | 19,2 | 2,9 | GGG 60 |
| 52.0250.03 | 250 | 3 | 8 ▲ | 2517 | 16-60 | 255,5 | 50 | 102 | 45 | 222 | 2,5 | 2,5 | 22,0 | 3,3 | GGG 60 |
| 52.0250.04 | 250 | 4 | 8 ▲ | 3020 | 25-75 | 255,5 | 65 | 125,5 | 51 | 222 | 7,0 | 7,0 | 30,0 | 4,5 | GGG 60 |
| 52.0250.05 | 250 | 5 | 8 ▲ | 3020 | 25-75 | 255,5 | 80 | 125,5 | 51 | 224 | 14,5 | 14,5 | 33,3 | 5,0 | GGG 60 |
| 52.0250.06 | 250 | 6 | 8 ▲ | 3020 | 25-75 | 255,5 | 95 | 125,5 | 51 | 224 | 22,0 | 22,0 | 37,3 | 5,6 | GGG 60 |
| 52.0280.01 | 280 | 1 | 9 ▲ | 2012 | 14-50 | 285,5 | 20 | 84 | 32 | 248 | 6,0 | 6,0 | 14,8 | 2,1 | GGG 60 |
| 52.0280.02 | 280 | 2 | 9 ▲ | 2517 | 16-60 | 285,5 | 35 | 102 | 45 | 248 | 5,0 | 5,0 | 24,2 | 3,3 | GGG 60 |
| 52.0280.03 | 280 | 3 | 8 ▲ | 2517 | 16-60 | 285,5 | 50 | 102 | 45 | 254 | 2,5 | 2,5 | 26,9 | 3,6 | GGG 60 |
| 52.0280.04 | 280 | 4 | 8 ▲ | 3020 | 25-75 | 285,5 | 65 | 125,5 | 51 | 254 | 7,0 | 7,5 | 36,2 | 4,9 | GGG 60 |
| 52.0280.05 | 280 | 5 | 8 ▲ | 3525 | 35-100 | 285,5 | 80 | 150 | 65 | 254 | 7,5 | 7,0 | 51,3 | 6,9 | GGG 60 |
| 52.0280.06 | 280 | 6 | 8 ▲ | 3525 | 35-100 | 285,5 | 95 | 150 | 65 | 245 | 15,0 | 15,0 | 58,2 | 7,8 | GGG 60 |
| 52.0315.01 | 315 | 1 | 9 ▲ | 2012 | 14-50 | 320,5 | 20 | 84 | 32 | 283 | 6,0 | 6,0 | 18,1 | 2,4 | GGG 60 |
| 52.0315.02 | 315 | 2 | 9 ▲ | 2517 | 16-60 | 320,5 | 35 | 102 | 45 | 283 | 5,0 | 5,0 | 30,2 | 3,5 | GGG 60 |
| 52.0315.03 | 315 | 3 | 9 ▲ | 3020 | 25-75 | 320,5 | 50 | 125,5 | 51 | 288 | 0,5 | 0,5 | 39,5 | 4,7 | GGG 60 |
| 52.0315.04 | 315 | 4 | 8 ▲ | 3020 | 25-75 | 320,5 | 65 | 125,5 | 51 | 288 | 7,0 | 7,0 | 46,2 | 5,5 | GGG 60 |
| 52.0315.05 | 315 | 5 | 8 ▲ | 3525 | 35-100 | 320,5 | 80 | 150 | 65 | 288 | 7,5 | 7,5 | 67,2 | 8,0 | GGG 60 |
| 52.0315.06 | 315 | 6 | 8 ▲ | 3525 | 35-100 | 320,5 | 95 | 150 | 65 | 288 | 15,0 | 15,0 | 74,8 | 8,9 | GGG 60 |
| 52.0355.01 | 355 | 1 | 9 ▲ | 2012 | 14-50 | 360,5 | 20 | 84 | 32 | 323 | 6,0 | 6,0 | 23,9 | 3,1 | GGG 60 |
| 52.0355.02 | 355 | 2 | 9 ▲ | 2517 | 16-60 | 360,5 | 35 | 102 | 45 | 323 | 5,0 | 5,0 | 38,1 | 3,8 | GGG 60 |
| 52.0355.03 | 355 | 3 | 9 ▲ | 3020 | 25-75 | 360,5 | 50 | 125,5 | 51 | 327 | 0,5 | 0,5 | 49,2 | 5,2 | GGG 60 |
| 52.0355.04 | 355 | 4 | 8 ▲ | 3020 | 25-75 | 360,5 | 65 | 125,5 | 51 | 327 | 7,0 | 7,0 | 58,7 | 6,2 | GGG 60 |
| 52.0355.05 | 355 | 5 | 8 ▲ | 3525 | 35-100 | 360,5 | 80 | 150 | 65 | 327 | 7,5 | 7,5 | 81,4 | 8,6 | GGG 60 |
| 52.0355.06 | 355 | 6 | 8 ▲ | 3525 | 35-100 | 360,5 | 95 | 150 | 65 | 327 | 15,0 | 15,0 | 92,8 | 9,7 | GGG 60 |
| 52.0400.01 | 400 | 1 | 9 ▲ | 2012 | 14-50 | 405,5 | 20 | 84 | 32 | 368 | 6,0 | 6,0 | 31,4 | 3,1 | GGG 60 |
| 52.0400.02 | 400 | 2 | 9 ▲ | 2517 | 16-60 | 405,5 | 35 | 102 | 45 | 368 | 5,0 | 5,0 | 51,8 | 4,5 | GGG 60 |
| 52.0400.03 | 400 | 3 | 9 ▲ | 3020 | 25-75 | 405,5 | 50 | 125,5 | 51 | 368 | 0,5 | 0,5 | 65,1 | 6,1 | GGG 60 |
| 52.0400.04 | 400 | 4 | 8 ▲ | 3020 | 25-75 | 405,5 | 65 | 125,5 | 51 | 368 | 7,0 | 7,0 | 81,1 | 7,6 | GGG 60 |
| 52.0400.05 | 400 | 5 | 8 ▲ | 3525 | 35-100 | 405,5 | 80 | 150 | 65 | 373 | 7,5 | 7,5 | 104,5 | 9,8 | GGG 60 |
| 52.0400.06 | 400 | 6 | 8 ▲ | 3525 | 35-100 | 405,5 | 95 | 150 | 65 | 373 | 15,0 | 15,0 | 118,4 | 11,1 | GGG 60 |

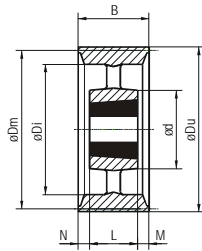

Type 8

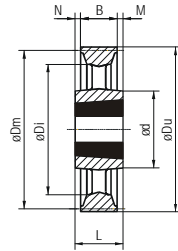

Type 9

| Code | Dm | Grooves Spor | Pulley Skive | Bush Bøsn. | Bore Udboring | Du | B | d | L | Di | M | N | Unbalance Ubalance | Weight Vægt | Matr. |
|------------|-----|-----------------|-----------------|---------------|------------------|-------|----|-------|----|-----|------|------|-----------------------|----------------|------------|
| EDB | mm | no./antal | type | type | mm | mm | mm | mm | mm | mm | mm | mm | gcm (max) | kg | DIN1691/93 |
| 52.0450.01 | 450 | 1 | 9 ▲ | 2517 | 16-60 | 455,5 | 20 | 102 | 45 | 418 | 12,5 | 12,5 | 50,4 | 5,9 | GGG 60 |
| 52.0450.02 | 450 | 2 | 9 ▲ | 2517 | 16-60 | 455,5 | 35 | 102 | 45 | 420 | 5,0 | 5,0 | 73,2 | 6,1 | GGG 60 |
| 52.0450.03 | 450 | 3 | 9 ▲ | 3020 | 25-75 | 455,5 | 50 | 125,5 | 51 | 420 | 0,5 | 0,5 | 92,4 | 7,7 | GGG 60 |
| 52.0450.04 | 450 | 4 | 8 ▲ | 3020 | 25-75 | 455,5 | 65 | 125,5 | 51 | 420 | 7,0 | 7,0 | 106,8 | 8,9 | GGG 60 |
| 52.0450.05 | 450 | 5 | 8 ▲ | 3525 | 35-100 | 455,5 | 80 | 150 | 65 | 420 | 7,5 | 7,5 | 144,0 | 12,0 | GGG 60 |
| 52.0450.06 | 450 | 6 | 8 ▲ | 3525 | 35-100 | 455,5 | 95 | 150 | 65 | 420 | 15,0 | 15,0 | 166,8 | 13,9 | GGG 60 |
| 52.0500.01 | 500 | 1 | 9 ▲ | 2517 | 16-60 | 505,5 | 20 | 102 | 45 | 468 | 12,5 | 12,5 | 64,0 | 7,7 | GGG 60 |
| 52.0500.02 | 500 | 2 | 9 ▲ | 2517 | 16-60 | 505,5 | 35 | 102 | 45 | 470 | 5,0 | 5,0 | 100,0 | 7,5 | GGG 60 |
| 52.0500.03 | 500 | 3 | 9 ▲ | 3020 | 25-75 | 505,5 | 50 | 125,5 | 51 | 470 | 0,5 | 0,5 | 121,3 | 9,1 | GGG 60 |
| 52.0500.04 | 500 | 4 | 8 ▲ | 3020 | 25-75 | 505,5 | 65 | 125,5 | 51 | 468 | 7,0 | 7,0 | 138,7 | 10,4 | GGG 60 |
| 52.0500.05 | 500 | 5 | 8 ▲ | 3525 | 35-100 | 505,5 | 80 | 150 | 65 | 470 | 7,5 | 7,5 | 182,7 | 13,7 | GGG 60 |
| 52.0500.06 | 500 | 6 | 8 ▲ | 3525 | 35-100 | 505,5 | 95 | 150 | 65 | 470 | 15,0 | 15,0 | 205,3 | 15,4 | GGG 60 |
| 52.0630.01 | 630 | 1 | 9 ▲ | 2517 | 16-60 | 635,5 | 20 | 102 | 45 | 598 | 12,5 | 12,5 | 101,8 | 9,9 | GGG 60 |
| 52.0630.02 | 630 | 2 | 9 ▲ | 3020 | 25-75 | 635,5 | 35 | 125,5 | 51 | 598 | 8,0 | 8,0 | 161,3 | 12,3 | GGG 60 |
| 52.0630.03 | 630 | 3 | 9 ▲ | 3020 | 25-75 | 635,5 | 50 | 125,5 | 51 | 598 | 0,5 | 0,5 | 221,8 | 14,0 | GGG 60 |
| 52.0630.04 | 630 | 4 | 8 ▲ | 3525 | 35-100 | 635,5 | 65 | 150 | 65 | 598 | - | - | 282,2 | 19,0 | GGG 60 |
| 52.0630.05 | 630 | 5 | 8 ▲ | 3525 | 35-100 | 635,5 | 80 | 150 | 65 | 598 | 7,5 | 7,5 | 324,6 | 20,6 | GGG 60 |
| 52.0630.06 | 630 | 6 | 8 ▲ | 4030 | 40-115 | 635,5 | 95 | 176 | 76 | 595 | 9,5 | 9,5 | 492,9 | 25,2 | GGG 60 |
| 52.0800.03 | 800 | 3 | 9 ▲ | 3525 | 35-100 | 806,0 | 50 | 150 | 65 | 765 | 7,5 | 7,5 | 519,7 | 24,4 | GGG 60 |
| 52.0800.04 | 800 | 4 | 8 ▲ | 3525 | 35-100 | 806,0 | 65 | 150 | 65 | 765 | 0,0 | 0,0 | 638,7 | 29,9 | GGG 60 |
| 52.0800.05 | 800 | 5 | 8 ▲ | 4030 | 40-115 | 806,0 | 80 | 176 | 76 | 765 | 2,0 | 2,0 | 765,4 | 35,9 | GGG 60 |
| 52.0800.06 | 800 | 6 | 8 ▲ | 4030 | 40-115 | 806,0 | 95 | 176 | 76 | 765 | 9,5 | 9,5 | 865,3 | 33,0 | GGG 60 |

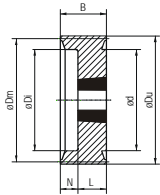

Type 3

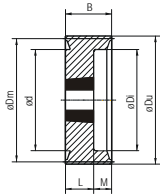

Type 4

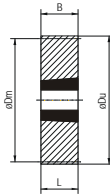

Type 6

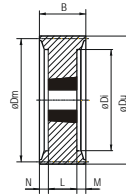

Type 7

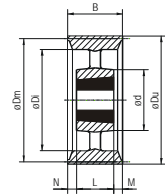

Type 8

| Code | Dm | Grooves Spor | Pulley Skive | Bush Bøsn. | Bore Udboring | Du | B | d | L | Di | M | N | Unbalance Ubalance | Weight Vægt | Matr. |
|------------|-----|-----------------|-----------------|---------------|------------------|-----|-----|----|----|-----|------|------|-----------------------|----------------|------------|
| EDB | mm | no./antal | type | type | mm | mm | mm | mm | mm | mm | mm | mm | gcm (max) | kg | DIN1691/93 |
| 63.0100.01 | 100 | 1 | 6 ● | 1610 | 14-42 | 107 | 25 | - | 25 | - | - | - | 5,1 | 1,0 | GG-25 |
| 63.0100.02 | 100 | 2 | 3 ● | 1610 | 14-42 | 107 | 44 | - | 25 | 62 | - | 19,0 | 7,6 | 1,5 | GG-25 |
| 63.0100.03 | 100 | 3 | 3 ● | 1610 | 14-42 | 107 | 63 | - | 25 | 62 | - | 38,0 | 8,7 | 1,7 | GG-25 |
| 63.0112.01 | 112 | 1 | 6 ● | 1610 | 14-42 | 119 | 25 | - | 25 | - | - | - | 5,6 | 1,1 | GG-25 |
| 63.0112.02 | 112 | 2 | 3 ● | 2012 | 14-50 | 119 | 44 | - | 32 | 74 | - | 12,0 | 9,2 | 1,8 | GG-25 |
| 63.0112.03 | 112 | 3 | 3 ● | 2012 | 14-50 | 119 | 63 | - | 32 | 74 | - | 31,0 | 9,7 | 1,9 | GG-25 |
| 63.0118.01 | 118 | 1 | 6 ● | 1610 | 14-42 | 125 | 25 | - | 25 | - | - | - | 6,6 | 1,3 | GG-25 |
| 63.0118.02 | 118 | 2 | 3 ● | 2012 | 14-50 | 125 | 44 | - | 32 | 80 | - | 12,0 | 8,2 | 1,6 | GG-25 |
| 63.0118.03 | 118 | 3 | 3 ● | 2012 | 14-50 | 125 | 63 | - | 32 | 80 | - | 31,0 | 12,2 | 2,4 | GG-25 |
| 63.0125.01 | 125 | 1 | 6 ● | 1610 | 14-42 | 132 | 25 | - | 25 | - | - | - | 6,6 | 1,3 | GG-25 |
| 63.0125.02 | 125 | 2 | 3 ● | 2012 | 14-50 | 132 | 44 | - | 32 | 87 | - | 12,0 | 9,7 | 1,9 | GG-25 |
| 63.0125.03 | 125 | 3 | 4 ● | 2012 | 14-50 | 132 | 63 | - | 32 | 87 | 31,0 | - | 12,2 | 2,4 | GG-25 |
| 63.0125.04 | 125 | 4 | 4 ● | 2012 | 14-50 | 132 | 82 | - | 32 | 87 | 50,0 | - | 15,3 | 3,0 | GG-25 |
| 63.0125.05 | 125 | 5 | 4 ● | 2012 | 14-50 | 132 | 101 | - | 32 | 87 | 69,0 | - | 17,8 | 3,5 | GG-25 |
| 63.0132.01 | 132 | 1 | 6 ● | 1610 | 14-42 | 139 | 25 | - | 25 | - | - | - | 8,2 | 1,6 | GG-25 |
| 63.0132.02 | 132 | 2 | 3 ● | 2012 | 14-50 | 139 | 44 | - | 32 | 94 | - | 12,0 | 11,2 | 2,2 | GG-25 |
| 63.0132.03 | 132 | 3 | 4 ● | 2012 | 14-50 | 139 | 63 | - | 32 | 94 | 31,0 | - | 14,3 | 2,8 | GG-25 |
| 63.0132.04 | 132 | 4 | 4 ● | 2012 | 14-50 | 139 | 82 | - | 32 | 94 | 50,0 | - | 17,3 | 3,4 | GG-25 |
| 63.0132.05 | 132 | 5 | 3 ● | 2517 | 16-60 | 139 | 101 | - | 45 | 94 | - | 56,0 | 18,9 | 3,7 | GG-25 |
| 63.0140.01 | 140 | 1 | 6 ● | 1610 | 14-42 | 147 | 25 | - | 25 | - | - | - | 10,2 | 2,0 | GG-25 |
| 63.0140.02 | 140 | 2 | 3 ● | 2012 | 14-50 | 147 | 44 | - | 32 | 102 | - | 12,0 | 13,8 | 2,7 | GG-30 |
| 63.0140.03 | 140 | 3 | 4 ● | 2012 | 14-50 | 147 | 63 | - | 32 | 102 | 31,0 | - | 16,8 | 3,3 | GG-25 |
| 63.0140.04 | 140 | 4 | 4 ● | 2517 | 16-60 | 147 | 82 | - | 45 | 102 | 37,0 | - | 18,9 | 3,7 | GG-25 |
| 63.0140.05 | 140 | 5 | 4 ● | 2517 | 16-60 | 147 | 101 | - | 45 | 102 | 56,0 | - | 22,9 | 4,5 | GG-25 |
| 63.0140.06 | 140 | 6 | 7 ● | 2517 | 16-60 | 147 | 120 | - | 45 | 102 | 60,0 | 15,0 | 23,4 | 4,6 | GG-25 |
| 63.0150.01 | 150 | 1 | 6 ● | 1610 | 14-42 | 157 | 25 | - | 25 | - | - | - | 12,2 | 2,4 | GG-25 |
| 63.0150.02 | 150 | 2 | 3 ● | 2012 | 14-50 | 157 | 44 | - | 32 | 112 | - | 12,0 | 15,8 | 3,1 | GG-25 |
| 63.0150.03 | 150 | 3 | 4 ● | 2517 | 16-60 | 157 | 63 | - | 45 | 112 | 18,0 | - | 19,9 | 3,9 | GG-25 |
| 63.0150.04 | 150 | 4 | 4 ● | 2517 | 16-60 | 157 | 82 | - | 45 | 112 | 37,0 | - | 22,4 | 4,4 | GG-25 |
| 63.0150.05 | 150 | 5 | 4 ● | 2517 | 16-60 | 157 | 101 | - | 45 | 112 | 56,0 | - | 26,5 | 5,2 | GG-25 |
| 63.0150.06 | 150 | 6 | 7 ● | 2517 | 16-60 | 157 | 120 | - | 45 | 112 | 60,0 | 15,0 | 28,5 | 5,6 | GG-25 |
| 63.0160.01 | 160 | 1 | 8 ○ | 1610 | 14-42 | 167 | 25 | 85 | 25 | - | - | - | 9,2 | 1,8 | GG-25 |
| 63.0160.02 | 160 | 2 | 4 ● | 2012 | 14-50 | 167 | 44 | - | 32 | 119 | 12,0 | - | 14,8 | 2,9 | GG-25 |
| 63.0160.03 | 160 | 3 | 4 ● | 2517 | 16-60 | 167 | 63 | 95 | 45 | 119 | 18,0 | - | 21,4 | 4,2 | GG-25 |
| 63.0160.04 | 160 | 4 | 7 ● | 2517 | 16-60 | 167 | 82 | - | 45 | 119 | 18,5 | 18,5 | 25,0 | 4,9 | GG-25 |
| 63.0160.05 | 160 | 5 | 4 ● | 2517 | 16-60 | 167 | 101 | - | 45 | 119 | 56,0 | - | 30,6 | 6,0 | GG-25 |
| 63.0160.06 | 160 | 6 | 7 ● | 3020 | 25-75 | 167 | 120 | - | 51 | 119 | 15,0 | 54,0 | 27,5 | 5,4 | GG-25 |
| 63.0170.01 | 170 | 1 | 8 ○ | 1610 | 14-42 | 177 | 25 | 85 | 25 | - | - | - | 9,7 | 1,9 | GG-25 |
| 63.0170.02 | 170 | 2 | 4 ● | 2012 | 14-50 | 177 | 44 | - | 32 | 129 | 12,0 | - | 16,8 | 3,3 | GG-25 |
| 63.0170.03 | 170 | 3 | 4 ● | 2517 | 16-60 | 177 | 63 | 95 | 45 | 129 | 18,0 | - | 25,0 | 4,9 | GG-25 |
| 63.0170.04 | 170 | 4 | 7 ● | 2517 | 16-60 | 177 | 82 | - | 45 | 129 | 18,5 | 18,5 | 29,0 | 5,7 | GG-25 |
| 63.0170.05 | 170 | 5 | 4 ● | 3020 | 25-75 | 177 | 101 | - | 51 | 129 | 50,0 | - | 31,1 | 6,1 | GG-25 |
| 63.0170.06 | 170 | 6 | 7 ● | 3020 | 25-75 | 177 | 120 | - | 51 | 129 | 54,0 | 15,0 | 33,1 | 6,5 | GG-25 |
| 63.0170.08 | 170 | 8 | 7 ● | 3020 | 25-75 | 177 | 158 | - | 51 | 129 | 53,5 | 53,5 | 36,7 | 7,2 | GG-25 |

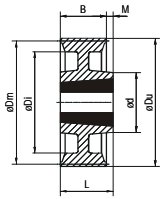

Type 2

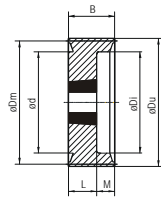

Type 4

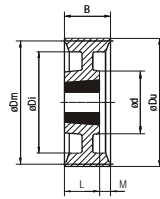

Type 5

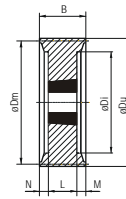

Type 7

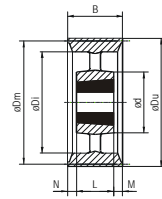

Type 8

| Code | Dm | Grooves Spor | Pulley Skive | Bush Bøsn. | Bore Udboring | Du | B | d | L | Di | M | N | Unbalance Ubalance | Weight Vægt | Matr. |
|------------|-----|-----------------|-----------------|---------------|------------------|-----|-----|-------|----|-----|------|------|-----------------------|----------------|------------|
| EDB | mm | no./antal | type | type | mm | mm | mm | mm | mm | mm | mm | mm | gcm (max) | kg | DIN1691/93 |
| 53.0180.01 | 180 | 1 | 8 ▲ | 1610 | 14-42 | 187 | 25 | 74 | 25 | 146 | - | - | 6,4 | 1,2 | GGG 60 |
| 53.0180.02 | 180 | 2 | 2 ▲ | 2517 | 16-60 | 187 | 44 | 102 | 45 | 146 | 1,0 | - | 13,8 | 2,4 | GGG 60 |
| 53.0180.03 | 180 | 3 | 5 ▲ | 2517 | 16-60 | 187 | 63 | 102 | 45 | 146 | 18,0 | - | 15,3 | 3,0 | GGG 60 |
| 53.0180.04 | 180 | 4 | 8 ▲ | 2517 | 16-60 | 187 | 82 | 102 | 45 | 146 | 18,5 | 18,5 | 18,3 | 3,6 | GGG 60 |
| 63.0180.05 | 180 | 5 | 4 ● | 3020 | 25-75 | 187 | 101 | - | 51 | 139 | 50,0 | - | 36,2 | 7,1 | GG-25 |
| 63.0180.06 | 180 | 6 | 7 ● | 3020 | 25-75 | 187 | 120 | - | 51 | 139 | 54,0 | 15,0 | 39,2 | 7,7 | GG-25 |
| 63.0180.08 | 180 | 8 | 7 ● | 3020 | 25-75 | 187 | 158 | - | 51 | 139 | 53,5 | 53,5 | 44,3 | 8,7 | GG-30 |
| 53.0190.01 | 190 | 1 | 2 ▲ | 2012 | 14-50 | 197 | 25 | 84 | 32 | 156 | 7,0 | - | 6,7 | 1,5 | GGG 60 |
| 53.0190.02 | 190 | 2 | 2 ▲ | 2517 | 16-60 | 197 | 44 | 102 | 45 | 156 | 1,0 | - | 15,3 | 2,6 | GGG 60 |
| 53.0190.03 | 190 | 3 | 5 ▲ | 2517 | 16-60 | 197 | 63 | 102 | 45 | 156 | 18,0 | - | 16,3 | 3,2 | GGG 60 |
| 53.0190.04 | 190 | 4 | 8 ▲ | 2517 | 16-60 | 197 | 82 | 102 | 45 | 156 | 18,5 | 18,5 | 19,4 | 3,8 | GGG 60 |
| 63.0190.05 | 190 | 5 | 4 ● | 3020 | 25-75 | 197 | 101 | - | 51 | 149 | 50,0 | - | 41,3 | 8,1 | GG-25 |
| 63.0190.06 | 190 | 6 | 7 ● | 3020 | 25-75 | 197 | 120 | - | 51 | 149 | 54,0 | 15,0 | 46,9 | 9,2 | GG-25 |
| 63.0190.08 | 190 | 8 | 7 ● | 3020 | 25-75 | 197 | 158 | - | 51 | 149 | 53,5 | 53,5 | 50,4 | 9,9 | GG-30 |
| 53.0200.01 | 200 | 1 | 2 ▲ | 2012 | 14-50 | 207 | 25 | 84 | 32 | 166 | 7,0 | - | 8,0 | 1,5 | GGG 60 |
| 53.0200.02 | 200 | 2 | 2 ▲ | 2517 | 16-60 | 207 | 44 | 102 | 45 | 166 | 1,0 | - | 17,3 | 2,7 | GGG 60 |
| 53.0200.03 | 200 | 3 | 5 ▲ | 2517 | 16-60 | 207 | 63 | 102 | 45 | 166 | 18,0 | - | 17,6 | 3,3 | GGG 60 |
| 53.0200.04 | 200 | 4 | 5 ▲ | 3020 | 25-75 | 207 | 82 | 125,5 | 51 | 166 | 31,0 | - | 20,3 | 4,6 | GGG 60 |
| 63.0200.05 | 200 | 5 | 4 ● | 3020 | 25-75 | 207 | 101 | - | 51 | 159 | 50,0 | - | 48,5 | 9,1 | GG-25 |
| 63.0200.06 | 200 | 6 | 7 ● | 3020 | 25-75 | 207 | 120 | - | 51 | 159 | 54,0 | 15,0 | 54,9 | 10,3 | GG-25 |
| 63.0200.08 | 200 | 8 | 7 ● | 3525 | 35-100 | 207 | 158 | - | 65 | 159 | 46,5 | 46,5 | 61,3 | 11,5 | GG-30 |
| 53.0212.01 | 212 | 1 | 2 ▲ | 2012 | 14-50 | 219 | 25 | 84 | 32 | 171 | 7,0 | - | 9,5 | 1,6 | GGG 60 |
| 53.0212.02 | 212 | 2 | 2 ▲ | 2517 | 16-60 | 219 | 44 | 102 | 45 | 171 | 1,0 | - | 16,6 | 2,9 | GGG 60 |
| 53.0212.03 | 212 | 3 | 5 ▲ | 2517 | 16-60 | 219 | 63 | 102 | 45 | 178 | 18,0 | - | 20,4 | 3,6 | GGG 60 |
| 53.0212.04 | 212 | 4 | 8 ▲ | 3020 | 25-75 | 219 | 82 | 125,5 | 51 | 178 | 15,5 | 15,5 | 26,6 | 4,8 | GGG 60 |
| 53.0212.05 | 212 | 5 | 5 ▲ | 3020 | 25-75 | 219 | 101 | 125,5 | 51 | 178 | 50,0 | - | 32,2 | 5,7 | GGG 60 |
| 63.0212.06 | 212 | 6 | 4 ● | 3525 | 35-100 | 219 | 120 | 180 | 65 | 171 | 55,0 | - | 67,8 | 12,0 | GG-25 |
| 63.0212.08 | 212 | 8 | 7 ● | 3525 | 35-100 | 219 | 158 | - | 65 | 171 | 46,5 | 46,5 | 80,8 | 14,3 | GG-30 |
| 53.0224.01 | 224 | 1 | 2 ▲ | 2012 | 14-50 | 231 | 25 | 84 | 32 | 184 | 7,0 | - | 10,4 | 1,8 | GGG 60 |
| 53.0224.02 | 224 | 2 | 2 ▲ | 2517 | 16-60 | 231 | 44 | 102 | 45 | 184 | 1,0 | - | 19,0 | 3,0 | GGG 60 |
| 53.0224.03 | 224 | 3 | 5 ▲ | 2517 | 16-60 | 231 | 63 | 102 | 45 | 191 | 18,0 | - | 21,5 | 3,6 | GGG 60 |
| 53.0224.04 | 224 | 4 | 8 ▲ | 3020 | 25-75 | 231 | 82 | 125,5 | 51 | 191 | 15,5 | 15,5 | 29,9 | 5,0 | GGG 60 |
| 53.0224.05 | 224 | 5 | 5 ▲ | 3020 | 25-75 | 231 | 101 | 125,5 | 51 | 191 | 50,0 | - | 35,8 | 6,0 | GGG 60 |
| 63.0224.06 | 224 | 6 | 4 ● | 3525 | 35-100 | 231 | 120 | 180 | 65 | 184 | 55,0 | - | 87,8 | 14,7 | GG-30 |
| 63.0224.08 | 224 | 8 | 7 ● | 3525 | 35-100 | 231 | 158 | - | 65 | 184 | 46,5 | 46,5 | 101,5 | 17,0 | GG-30 |
| 63.0224.10 | 224 | 10 | 7 ● | 3535 | 35-90 | 231 | 196 | - | 89 | 184 | 61,0 | 46,0 | 128,4 | 21,5 | GG-30 |
| 53.0236.01 | 236 | 1 | 2 ▲ | 2012 | 14-50 | 243 | 25 | 84 | 32 | 198 | 7,0 | - | 10,6 | 1,8 | GGG 60 |
| 53.0236.02 | 236 | 2 | 2 ▲ | 2517 | 16-60 | 243 | 44 | 102 | 45 | 198 | 1,0 | - | 20,4 | 3,2 | GGG 60 |
| 53.0236.03 | 236 | 3 | 5 ▲ | 2517 | 16-60 | 243 | 63 | 102 | 45 | 202 | 18,0 | - | 25,2 | 4,0 | GGG 60 |
| 53.0236.04 | 236 | 4 | 8 ▲ | 3020 | 25-75 | 243 | 82 | 125,5 | 51 | 202 | 15,5 | 15,5 | 32,1 | 5,1 | GGG 60 |
| 53.0236.05 | 236 | 5 | 5 ▲ | 3525 | 35-100 | 243 | 101 | 150 | 65 | 202 | 36,0 | - | 48,5 | 7,7 | GGG 60 |
| 53.0236.06 | 236 | 6 | 5 ▲ | 3525 | 35-100 | 243 | 120 | 150 | 65 | 202 | 55,0 | - | 52,9 | 8,4 | GGG 60 |
| 53.0236.08 | 236 | 8 | 8 ▲ | 3525 | 35-100 | 243 | 158 | 150 | 65 | 202 | 46,5 | 46,5 | 63,6 | 10,1 | GGG 60 |
| 53.0236.10 | 236 | 10 | 8 ▲ | 3525 | 35-100 | 243 | 196 | 150 | 65 | 202 | 65,5 | 65,5 | 74,9 | 11,9 | GGG 60 |
| 53.0250.01 | 250 | 1 | 2 ▲ | 2012 | 14-50 | 257 | 25 | 84 | 32 | 216 | 7,0 | - | 14,0 | 2,0 | GGG 60 |
| 53.0250.02 | 250 | 2 | 2 ▲ | 2517 | 16-60 | 257 | 44 | 102 | 45 | 216 | 1,0 | - | 19,7 | 3,0 | GGG 60 |
| 53.0250.03 | 250 | 3 | 8 ▲ | 3020 | 25-75 | 257 | 63 | 125,5 | 51 | 216 | 6,0 | 6,0 | 28,7 | 4,3 | GGG 60 |
| 53.0250.04 | 250 | 4 | 8 ▲ | 3020 | 25-75 | 257 | 82 | 125,5 | 51 | 216 | 15,5 | 15,5 | 36,0 | 5,4 | GGG 60 |
| 53.0250.05 | 250 | 5 | 5 ▲ | 3525 | 35-100 | 257 | 101 | 150 | 65 | 216 | 36,0 | - | 50,7 | 7,6 | GGG 60 |
| 53.0250.06 | 250 | 6 | 5 ▲ | 3525 | 35-100 | 257 | 120 | 150 | 65 | 216 | 55,0 | - | 61,3 | 9,2 | GGG 60 |
| 53.0250.08 | 250 | 8 | 8 ▲ | 3525 | 35-100 | 257 | 158 | 150 | 65 | 215 | 46,5 | 46,5 | 70,7 | 10,6 | GGG 60 |
| 53.0250.10 | 250 | 10 | 8 ▲ | 3525 | 35-100 | 257 | 196 | 150 | 65 | 214 | 65,5 | 65,5 | 86,0 | 12,9 | GGG 60 |

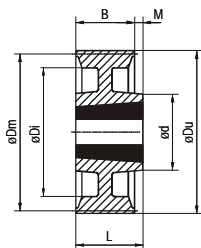

Type 2

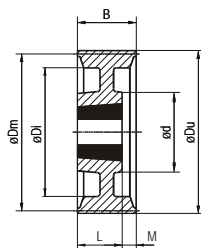

Type 5

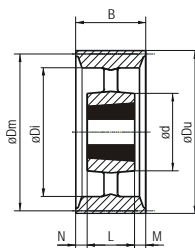

Type 8

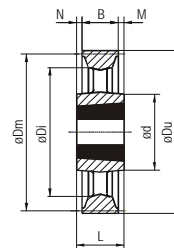

Type 9

| Code | Dm | Grooves Spor | Pulley Skive | Bush Bøsn. | Bore Udboring | Du | B | d | L | Di | M | N | Unbalance Ubalance | Weight Vægt | Matr. |
|------------|-----|--------------|--------------|------------|---------------|-----|-----|-------|----|-----|-------|------|--------------------|-------------|------------|
| EDB | mm | no./antal | type | type | mm | mm | mm | mm | mm | mm | mm | mm | gcm (max) | kg | DIN1691/93 |
| 53.0265.03 | 265 | 3 | 8 ▲ | 3020 | 25-75 | 272 | 63 | 125,5 | 51 | 230 | 6,0 | 6,0 | 43,8 | 6,2 | GGG 60 |
| 53.0265.04 | 265 | 4 | 8 ▲ | 3020 | 25-75 | 272 | 82 | 125,5 | 51 | 230 | 15,5 | 15,5 | 46,6 | 6,6 | GGG 60 |
| 53.0265.05 | 265 | 5 | 5 ▲ | 3525 | 35-100 | 272 | 101 | 150 | 65 | 230 | 36 | - | 67,1 | 9,5 | GGG 60 |
| 53.0265.06 | 265 | 6 | 5 ▲ | 3525 | 35-100 | 272 | 120 | 150 | 65 | 230 | 55 | - | 72,1 | 10,2 | GGG 60 |
| 53.0265.08 | 265 | 8 | 8 ▲ | 3525 | 35-100 | 272 | 158 | 150 | 65 | 230 | 46,5 | 46,5 | 91,9 | 13,0 | GGG 60 |
| 53.0265.10 | 265 | 10 | 8 ▲ | 3525 | 35-100 | 272 | 196 | 150 | 65 | 230 | 65,5 | 65,5 | 102,5 | 14,5 | GGG 60 |
| 53.0280.01 | 280 | 1 | 2 ▲ | 2012 | 14-50 | 287 | 25 | 84 | 32 | 249 | 7,0 | - | 14,9 | 2,0 | GGG 60 |
| 53.0280.02 | 280 | 2 | 2 ▲ | 2517 | 16-60 | 287 | 44 | 102 | 45 | 249 | 1,0 | - | 23,1 | 3,1 | GGG 60 |
| 53.0280.03 | 280 | 3 | 8 ▲ | 3020 | 25-75 | 287 | 63 | 125,5 | 51 | 249 | 6,0 | 6,0 | 38,1 | 5,1 | GGG 60 |
| 53.0280.04 | 280 | 4 | 8 ▲ | 3020 | 25-75 | 287 | 82 | 125,5 | 51 | 249 | 15,5 | 15,5 | 41,8 | 5,6 | GGG 60 |
| 53.0280.05 | 280 | 5 | 5 ▲ | 3525 | 35-100 | 287 | 101 | 150 | 65 | 249 | 36,0 | - | 64,2 | 8,6 | GGG 60 |
| 53.0280.06 | 280 | 6 | 5 ▲ | 3525 | 35-100 | 287 | 120 | 150 | 65 | 249 | 55,0 | - | 71,7 | 9,6 | GGG 60 |
| 53.0280.08 | 280 | 8 | 8 ▲ | 3525 | 35-100 | 287 | 158 | 150 | 65 | 249 | 46,5 | 46,5 | 84,7 | 12,2 | GGG 60 |
| 53.0280.10 | 280 | 10 | 8 ▲ | 3525 | 35-100 | 287 | 196 | 150 | 65 | 249 | 65,5 | 65,5 | 105,3 | 14,1 | GGG 60 |
| 53.0300.02 | 300 | 2 | 2 ▲ | 2517 | 16-60 | 307 | 44 | 102 | 45 | 264 | 1,0 | - | 34,4 | 4,3 | GGG 60 |
| 53.0300.03 | 300 | 3 | 8 ▲ | 3020 | 25-75 | 307 | 63 | 125,5 | 51 | 264 | 6,0 | 6,0 | 52,0 | 6,5 | GGG 60 |
| 53.0300.04 | 300 | 4 | 8 ▲ | 3020 | 25-75 | 307 | 82 | 125,5 | 51 | 264 | 15,5 | 15,5 | 57,6 | 7,2 | GGG 60 |
| 53.0300.05 | 300 | 5 | 5 ▲ | 3525 | 35-100 | 307 | 101 | 150 | 65 | 264 | 36,0 | - | 95,2 | 11,9 | GGG 60 |
| 53.0300.06 | 300 | 6 | 5 ▲ | 3525 | 35-100 | 307 | 120 | 150 | 65 | 264 | 55,0 | - | 105,6 | 13,2 | GGG 60 |
| 53.0300.08 | 300 | 8 | 8 ▲ | 3525 | 35-100 | 307 | 158 | 150 | 65 | 264 | 46,5 | 46,5 | 124,8 | 15,6 | GGG 60 |
| 53.0300.10 | 300 | 10 | 8 ▲ | 3525 | 35-100 | 307 | 196 | 150 | 65 | 264 | 65,5 | 65,5 | 139,2 | 17,4 | GGG 60 |
| 53.0315.01 | 315 | 1 | 2 ▲ | 2012 | 14-50 | 322 | 25 | 84 | 32 | 284 | 7,0 | - | 20,2 | 2,4 | GGG 60 |
| 53.0315.02 | 315 | 2 | 2 ▲ | 2517 | 16-60 | 322 | 44 | 102 | 45 | 284 | 1,0 | - | 30,2 | 3,6 | GGG 60 |
| 53.0315.03 | 315 | 3 | 8 ▲ | 3020 | 25-75 | 322 | 63 | 125,5 | 51 | 284 | 6,0 | 6,0 | 46,2 | 5,5 | GGG 60 |
| 53.0315.04 | 315 | 4 | 8 ▲ | 3525 | 35-100 | 322 | 82 | 150 | 65 | 284 | 8,5 | 8,5 | 69,7 | 8,3 | GGG 60 |
| 53.0315.05 | 315 | 5 | 8 ▲ | 3525 | 35-100 | 322 | 101 | 150 | 65 | 284 | 18,0 | 18,0 | 75,6 | 9,0 | GGG 60 |
| 53.0315.06 | 315 | 6 | 5 ▲ | 3525 | 35-100 | 322 | 120 | 150 | 65 | 284 | 55,0 | - | 89,9 | 10,7 | GGG 60 |
| 53.0315.08 | 315 | 8 | 8 ▲ | 3525 | 35-100 | 322 | 158 | 150 | 65 | 284 | 46,5 | 46,5 | 105,5 | 13,7 | GGG 60 |
| 53.0315.10 | 315 | 10 | 8 ▲ | 3525 | 35-100 | 322 | 196 | 150 | 65 | 284 | 65,55 | 65,5 | 137,8 | 16,4 | GGG 60 |
| 53.0335.02 | 335 | 2 | 2 ▲ | 2517 | 16-60 | 342 | 44 | 102 | 45 | 304 | 1,0 | - | 37,5 | 4,2 | GGG 60 |
| 53.0335.03 | 335 | 3 | 8 ▲ | 3020 | 25-75 | 342 | 63 | 125,5 | 51 | 304 | 6,0 | 6,0 | 51,8 | 5,8 | GGG 60 |
| 53.0335.04 | 335 | 4 | 8 ▲ | 3525 | 35-100 | 342 | 82 | 150 | 65 | 304 | 8,5 | 8,5 | 78,6 | 8,8 | GGG 60 |
| 53.0335.05 | 335 | 5 | 8 ▲ | 3525 | 35-100 | 342 | 101 | 150 | 65 | 304 | 18,0 | 18,0 | 91,1 | 10,2 | GGG 60 |
| 53.0335.06 | 335 | 6 | 8 ▲ | 3525 | 35-100 | 342 | 120 | 150 | 65 | 304 | 27,5 | 27,5 | 105,4 | 11,8 | GGG 60 |
| 53.0335.08 | 335 | 8 | 8 ▲ | 3525 | 35-100 | 342 | 158 | 150 | 65 | 304 | 46,5 | 46,5 | 123,3 | 14,7 | GGG 60 |
| 53.0335.10 | 335 | 10 | 8 ▲ | 4030 | 40-115 | 342 | 196 | 176 | 76 | 304 | 60,0 | 60,0 | 172,4 | 19,3 | GGG 60 |
| 53.0355.02 | 355 | 2 | 9 ▲ | 3020 | 25-75 | 362 | 44 | 125,5 | 51 | 324 | 3,5 | 3,5 | 50,2 | 5,3 | GGG 60 |
| 53.0355.03 | 355 | 3 | 8 ▲ | 3020 | 25-75 | 362 | 63 | 125,5 | 51 | 324 | 6,0 | 6,0 | 61,5 | 6,5 | GGG 60 |
| 53.0355.04 | 355 | 4 | 8 ▲ | 3525 | 35-100 | 362 | 82 | 150 | 65 | 324 | 8,5 | 8,5 | 93,7 | 9,9 | GGG 60 |
| 53.0355.05 | 355 | 5 | 8 ▲ | 3525 | 35-100 | 362 | 101 | 150 | 65 | 324 | 18,0 | 18,0 | 106,0 | 11,2 | GGG 60 |
| 53.0355.06 | 355 | 6 | 8 ▲ | 3525 | 35-100 | 362 | 120 | 150 | 65 | 324 | 27,5 | 27,5 | 125,9 | 13,3 | GGG 60 |
| 53.0355.08 | 355 | 8 | 8 ▲ | 3525 | 35-100 | 362 | 158 | 150 | 65 | 324 | 46,5 | 46,5 | 143,4 | 15,2 | GGG 60 |
| 53.0355.10 | 355 | 10 | 8 ▲ | 4030 | 40-115 | 362 | 196 | 176 | 76 | 324 | 60,0 | 60,0 | 200,7 | 21,2 | GGG 60 |
| 53.0400.02 | 400 | 2 | 9 ▲ | 3020 | 25-75 | 407 | 44 | 125,5 | 51 | 369 | 3,5 | 3,5 | 65,1 | 6,1 | GGG 60 |
| 53.0400.03 | 400 | 3 | 9 ▲ | 3525 | 35-100 | 407 | 63 | 150 | 65 | 369 | 1,0 | 1,0 | 103,8 | 9,7 | GGG 60 |
| 53.0400.04 | 400 | 4 | 8 ▲ | 3525 | 35-100 | 407 | 82 | 150 | 65 | 369 | 8,5 | 8,5 | 119,5 | 11,2 | GGG 60 |
| 53.0400.05 | 400 | 5 | 8 ▲ | 3525 | 35-100 | 407 | 101 | 150 | 65 | 369 | 18,0 | 18,0 | 136,5 | 12,8 | GGG 60 |
| 53.0400.06 | 400 | 6 | 8 ▲ | 3525 | 35-100 | 407 | 120 | 150 | 65 | 362 | 27,5 | 27,5 | 153,6 | 14,4 | GGG 60 |
| 53.0400.08 | 400 | 8 | 8 ▲ | 3525 | 35-100 | 407 | 158 | 150 | 65 | 362 | 46,5 | 46,5 | 189,9 | 17,8 | GGG 60 |
| 53.0400.10 | 400 | 10 | 8 ▲ | 4030 | 40-115 | 407 | 196 | 176 | 76 | 369 | 60,0 | 60,0 | 243,2 | 22,8 | GGG 60 |
| 53.0450.02 | 450 | 2 | 9 ▲ | 3020 | 25-75 | 457 | 44 | 125,5 | 51 | 416 | 3,5 | 3,5 | 100,8 | 8,4 | GGG 60 |
| 53.0450.03 | 450 | 3 | 9 ▲ | 3525 | 35-100 | 457 | 63 | 150 | 65 | 416 | 1,0 | 1,0 | 138,0 | 11,5 | GGG 60 |
| 53.0450.04 | 450 | 4 | 8 ▲ | 3525 | 35-100 | 457 | 82 | 150 | 65 | 416 | 8,5 | 8,5 | 159,6 | 13,3 | GGG 60 |
| 53.0450.05 | 450 | 5 | 8 ▲ | 3525 | 35-100 | 457 | 101 | 150 | 65 | 416 | 18,0 | 18,0 | 188,4 | 15,7 | GGG 60 |
| 53.0450.06 | 450 | 6 | 8 ▲ | 3525 | 35-100 | 457 | 120 | 150 | 65 | 416 | 27,5 | 27,5 | 205,2 | 17,1 | GGG 60 |
| 53.0450.08 | 450 | 8 | 8 ▲ | 3525 | 35-100 | 457 | 158 | 150 | 65 | 416 | 46,5 | 46,5 | 255,6 | 21,3 | GGG 60 |
| 53.0450.10 | 450 | 10 | 8 ▲ | 4535 | 55-125 | 457 | 196 | 198 | 89 | 410 | 53,5 | 53,5 | 351,6 | 29,3 | GGG 60 |

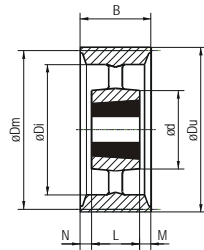

Type 8

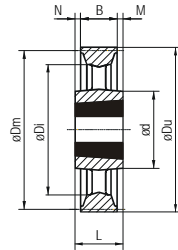

Type 9

| Code | Dm | Grooves Spor | Pulley Skive | Bush Bøsn. | Bore Udboring | Du | B | d | L | Di | M | N | Unbalance Ubalance | Weight Vægt | Matr. |
|------------|------|--------------|--------------|------------|---------------|------|-----|-------|-----|------|------|------|--------------------|-------------|------------|
| EDB | mm | no./antal | type | type | mm | mm | mm | mm | mm | mm | mm | mm | gcm (max) | kg | DIN1691/93 |
| 53.0500.02 | 500 | 2 | 9 ▲ | 3020 | 25-75 | 507 | 44 | 125,5 | 51 | 465 | 3,5 | 3,5 | 126,7 | 12,2 | GGG 60 |
| 53.0500.03 | 500 | 3 | 9 ▲ | 3525 | 35-100 | 507 | 63 | 150 | 65 | 465 | 1,0 | 1,0 | 168,0 | 12,6 | GGG 60 |
| 53.0500.04 | 500 | 4 | 8 ▲ | 3525 | 35-100 | 507 | 82 | 150 | 65 | 465 | 8,5 | 8,5 | 198,7 | 14,9 | GGG 60 |
| 53.0500.05 | 500 | 5 | 8 ▲ | 3525 | 35-100 | 507 | 101 | 150 | 65 | 465 | 18,0 | 18,0 | 234,7 | 17,6 | GGG 60 |
| 53.0500.06 | 500 | 6 | 8 ▲ | 3525 | 35-100 | 507 | 120 | 150 | 65 | 465 | 27,5 | 27,5 | 260,0 | 19,5 | GGG 60 |
| 53.0500.08 | 500 | 8 | 8 ▲ | 3525 | 35-100 | 507 | 158 | 150 | 65 | 465 | 46,5 | 46,5 | 324,0 | 24,3 | GGG 60 |
| 53.0500.10 | 500 | 10 | 8 ▲ | 4535 | 55-125 | 507 | 196 | 198 | 89 | 465 | 53,5 | 53,5 | 438,7 | 32,9 | GGG 60 |
| 53.0560.02 | 560 | 2 | 9 ▲ | 3020 | 25-75 | 567 | 44 | 125,5 | 51 | 524 | 3,5 | 3,5 | 204,6 | 13,7 | GGG 60 |
| 53.0560.03 | 560 | 3 | 9 ▲ | 3525 | 35-100 | 567 | 63 | 150 | 65 | 524 | 1,0 | 1,0 | 249,4 | 16,7 | GGG 60 |
| 53.0560.04 | 560 | 4 | 8 ▲ | 3525 | 35-100 | 567 | 82 | 150 | 65 | 524 | 8,5 | 8,5 | 288,2 | 19,3 | GGG 60 |
| 53.0560.05 | 560 | 5 | 8 ▲ | 3525 | 35-100 | 567 | 101 | 150 | 65 | 524 | 18,0 | 18,0 | 341,2 | 22,9 | GGG 60 |
| 53.0560.06 | 560 | 6 | 8 ▲ | 3525 | 35-100 | 567 | 120 | 150 | 65 | 524 | 27,5 | 27,5 | 368,1 | 24,7 | GGG 60 |
| 53.0560.08 | 560 | 8 | 8 ▲ | 4030 | 40-115 | 567 | 158 | 176 | 76 | 524 | 41,0 | 41,0 | 519,7 | 34,8 | GGG 60 |
| 53.0560.10 | 560 | 10 | 8 ▲ | 4535 | 55-125 | 567 | 196 | 198 | 89 | 524 | 53,5 | 53,5 | 622,7 | 41,7 | GGG 60 |
| 53.0630.02 | 630 | 2 | 9 ▲ | 3020 | 25-75 | 637 | 44 | 125,5 | 51 | 597 | 3,5 | 3,5 | 213,4 | 12,7 | GGG 60 |
| 53.0630.03 | 630 | 3 | 9 ▲ | 3525 | 35-100 | 637 | 63 | 150 | 65 | 597 | 1,0 | 1,0 | 263,1 | 18,8 | GGG 60 |
| 53.0630.04 | 630 | 4 | 8 ▲ | 3525 | 35-100 | 637 | 82 | 150 | 65 | 597 | 8,5 | 8,5 | 307,4 | 23,4 | GGG 60 |
| 53.0630.05 | 630 | 5 | 8 ▲ | 3525 | 35-100 | 637 | 101 | 150 | 65 | 597 | 18,0 | 18,0 | 342,7 | 25,2 | GGG 60 |
| 53.0630.06 | 630 | 6 | 8 ▲ | 3525 | 35-100 | 637 | 120 | 150 | 65 | 597 | 27,5 | 27,5 | 406,2 | 27,9 | GGG 60 |
| 53.0630.08 | 630 | 8 | 8 ▲ | 4030 | 40-115 | 637 | 158 | 176 | 76 | 597 | 41,0 | 41,0 | 566,5 | 35,1 | GGG 60 |
| 53.0630.10 | 630 | 10 | 8 ▲ | 4535 | 55-125 | 637 | 196 | 198 | 89 | 597 | 53,5 | 53,5 | 723,7 | 45,0 | GGG 60 |
| 53.0710.02 | 710 | 2 | 9 ▲ | 3020 | 25-75 | 717 | 44 | 125,5 | 51 | 670 | 3,5 | 3,5 | 256,7 | 17,6 | GGG 60 |
| 53.0710.03 | 710 | 3 | 9 ▲ | 3525 | 35-100 | 717 | 63 | 150 | 65 | 670 | 1,0 | 1,0 | 343,1 | 21,6 | GGG 60 |
| 53.0710.04 | 710 | 4 | 8 ▲ | 3525 | 35-100 | 717 | 82 | 150 | 65 | 670 | 8,5 | 8,5 | 411,2 | 25,2 | GGG 60 |
| 53.0710.05 | 710 | 5 | 8 ▲ | 4030 | 40-115 | 717 | 101 | 176 | 76 | 670 | 12,5 | 12,5 | 516,9 | 33,9 | GGG 60 |
| 53.0710.06 | 710 | 6 | 8 ▲ | 4535 | 55-125 | 717 | 120 | 198 | 89 | 670 | 15,5 | 15,5 | 639,6 | 38,2 | GGG 60 |
| 53.0710.08 | 710 | 8 | 8 ▲ | 4535 | 55-125 | 717 | 158 | 198 | 89 | 670 | 34,5 | 34,5 | 739,5 | 46,8 | GGG 60 |
| 53.0710.10 | 710 | 10 | 8 ▲ | 4535 | 55-125 | 717 | 196 | 198 | 89 | 670 | 53,5 | 53,5 | 1079,2 | 57,0 | GGG 60 |
| 53.0800.02 | 800 | 2 | 9 ▲ | 3525 | 35-100 | 807 | 44 | 150 | 65 | 760 | 10,5 | 10,5 | 376,3 | 31,6 | GGG 60 |
| 53.0800.03 | 800 | 3 | 9 ▲ | 3525 | 35-100 | 807 | 63 | 150 | 65 | 760 | 1,0 | 1,0 | 430,1 | 33,6 | GGG 60 |
| 53.0800.04 | 800 | 4 | 8 ▲ | 4030 | 40-115 | 807 | 82 | 176 | 76 | 760 | 3,0 | 3,0 | 563,2 | 35,7 | GGG 60 |
| 53.0800.05 | 800 | 5 | 8 ▲ | 4030 | 40-115 | 807 | 101 | 176 | 76 | 760 | 12,5 | 12,5 | 657,9 | 48,9 | GGG 60 |
| 53.0800.06 | 800 | 6 | 8 ▲ | 4535 | 55-125 | 807 | 120 | 198 | 89 | 760 | 15,5 | 15,5 | 797,4 | 51,0 | GGG 60 |
| 53.0800.08 | 800 | 8 | 8 ▲ | 4535 | 55-125 | 807 | 158 | 198 | 89 | 760 | 34,5 | 34,5 | 1002,2 | 60,0 | GGG 60 |
| 53.0800.10 | 800 | 10 | 8 ▲ | 4535 | 55-125 | 807 | 196 | 198 | 89 | 760 | 53,5 | 53,5 | 1305,6 | 63,0 | GGG 60 |
| 53.0900.03 | 900 | 3 | 9 ▲ | 3525 | 35-100 | 907 | 63 | 150 | 65 | 858 | 1,0 | 1,0 | 574,6 | 51,0 | GGG 60 |
| 53.0900.04 | 900 | 4 | 8 ▲ | 4030 | 40-115 | 907 | 82 | 176 | 76 | 858 | 3,0 | 3,0 | 793,4 | 55,0 | GGG 60 |
| 53.0900.05 | 900 | 5 | 8 ▲ | 4535 | 55-125 | 907 | 101 | 198 | 89 | 858 | 6,0 | 6,0 | 954,7 | 39,8 | GGG 60 |
| 53.0900.06 | 900 | 6 | 8 ▲ | 4535 | 55-125 | 907 | 120 | 198 | 89 | 858 | 15,5 | 15,5 | 1062,7 | 44,3 | GGG 60 |
| 53.0900.08 | 900 | 8 | 8 ▲ | 4535 | 55-125 | 907 | 158 | 198 | 89 | 858 | 34,5 | 34,5 | 1496,2 | 69,1 | GGG 60 |
| 53.0900.10 | 900 | 10 | 8 ▲ | 5040 | 70-125 | 907 | 196 | 218 | 102 | 858 | 47,0 | 47,0 | 1814,4 | 75,6 | GGG 60 |
| 53.1000.03 | 1000 | 3 | 9 ▲ | 4030 | 40-115 | 1007 | 63 | 176 | 76 | 958 | 6,5 | 6,5 | 832,0 | 57,0 | GGG 60 |
| 53.1000.04 | 1000 | 4 | 8 ▲ | 4030 | 40-115 | 1007 | 82 | 176 | 76 | 958 | 3,0 | 3,0 | 992,0 | 62,0 | GGG 60 |
| 53.1000.05 | 1000 | 5 | 8 ▲ | 4535 | 55-125 | 1007 | 101 | 198 | 89 | 958 | 6,0 | 6,0 | 1196,8 | 64,5 | GGG 60 |
| 53.1000.06 | 1000 | 6 | 8 ▲ | 4535 | 55-125 | 1007 | 120 | 198 | 89 | 958 | 15,5 | 15,5 | 1348,8 | 50,6 | GGG 60 |
| 53.1000.08 | 1000 | 8 | 8 ▲ | 4535 | 55-125 | 1007 | 158 | 198 | 89 | 958 | 34,5 | 34,5 | 1916,8 | 71,9 | GGG 60 |
| 53.1000.10 | 1000 | 10 | 8 ▲ | 5040 | 70-125 | 1007 | 196 | 218 | 102 | 958 | 47,0 | 47,0 | 2352,0 | 88,2 | GGG 60 |
| 53.1250.03 | 1250 | 3 | 9 ▲ | 5040 | 70-125 | 1257 | 63 | 218 | 102 | 1208 | 6,5 | 6,5 | 2400,0 | 71,0 | GGG 60 |
| 53.1250.04 | 1250 | 4 | 9 ▲ | 5040 | 70-125 | 1257 | 82 | 218 | 102 | 1208 | 3,5 | 3,5 | 3040,0 | 77,0 | GGG 60 |
| 53.1250.05 | 1250 | 5 | 8 ▲ | 5040 | 70-125 | 1257 | 101 | 218 | 102 | 1208 | 6,0 | 6,0 | 3500,0 | 86,0 | GGG 60 |
| 53.1250.06 | 1250 | 6 | 9 ▲ | 5040 | 70-125 | 1257 | 120 | 218 | 102 | 1208 | 9,0 | 9,0 | 3800,0 | 91,5 | GGG 60 |
| 53.1250.08 | 1250 | 8 | 8 ▲ | 5040 | 70-125 | 1257 | 158 | 218 | 102 | 1209 | 15,5 | 15,5 | 3300,0 | 99,0 | GGG 60 |

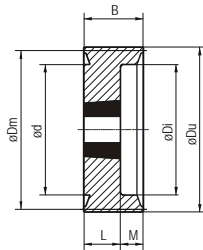

Type 4

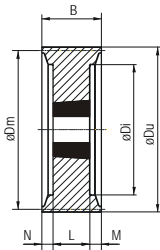

Type 7

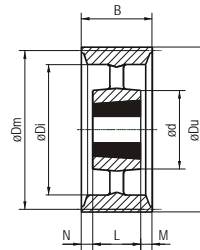

Type 8

| Code | Dm | Grooves Spor | Pulley Skive | Bush Bøsn. | Bore Udboring | Du | B | d | L | Di | M | N | Unbalance Ubalance | Weight Vægt | Matr. |
|------------|-----|--------------|--------------|------------|---------------|-------|-------|-------|----|-----|-------|-------|--------------------|-------------|------------|
| EDB | mm | no./antal | type | type | mm | mm | mm | mm | mm | mm | mm | mm | gcm (max) | kg | DIN1691/93 |
| 64.0200.03 | 200 | 3 | 7 ● | 2517 | 16-60 | 209,5 | 85 | - | 45 | 150 | 20,0 | 20,0 | 48,0 | 9,0 | GG-30 |
| 64.0200.04 | 200 | 4 | 7 ● | 3020 | 25-75 | 209,5 | 110,5 | - | 51 | 150 | 29,75 | 29,75 | 59,7 | 11,2 | GG-30 |
| 64.0200.05 | 200 | 5 | 7 ● | 3525 | 35-100 | 209,5 | 136 | - | 65 | 150 | 35,5 | 35,5 | 59,2 | 11,1 | GG-30 |
| 64.0200.06 | 200 | 6 | 7 ● | 3525 | 35-100 | 209,5 | 161,5 | - | 65 | 150 | 48,25 | 48,25 | 72,0 | 13,5 | GG-30 |
| 64.0200.08 | 200 | 8 | 7 ● | 3525 | 35-100 | 209,5 | 212,5 | - | 65 | 150 | 73,75 | 73,75 | 97,6 | 18,3 | GG-30 |
| 54.0212.03 | 212 | 3 | 7 ▲ | 3020 | 25-75 | 221,5 | 85 | 125,5 | 51 | 167 | 17,0 | 17,0 | 29,4 | 5,2 | GGG 60 |
| 64.0212.04 | 212 | 4 | 7 ● | 3020 | 25-75 | 221,5 | 110,5 | - | 51 | 162 | 29,75 | 29,75 | 69,5 | 12,3 | GG-30 |
| 64.0212.05 | 212 | 5 | 7 ● | 3525 | 35-100 | 221,5 | 136 | - | 65 | 162 | 35,5 | 35,5 | 72,9 | 12,9 | GG-30 |
| 64.0212.06 | 212 | 6 | 7 ● | 3525 | 35-100 | 221,5 | 161,5 | - | 65 | 162 | 48,25 | 48,25 | 84,8 | 15,0 | GG-30 |
| 64.0212.08 | 212 | 8 | 7 ● | 3525 | 35-100 | 221,5 | 212,5 | - | 65 | 162 | 73,75 | 73,75 | 108,5 | 19,2 | GG-30 |
| 54.0224.03 | 224 | 3 | 8 ▲ | 3020 | 25-75 | 233,5 | 85 | 125,5 | 51 | 179 | 17,0 | 17,0 | 33,5 | 5,6 | GGG 60 |
| 64.0224.04 | 224 | 4 | 7 ● | 3525 | 35-100 | 233,5 | 110,5 | - | 65 | 174 | 22,75 | 22,75 | 72,9 | 12,2 | GG-30 |
| 64.0224.05 | 224 | 5 | 7 ● | 3525 | 35-100 | 233,5 | 136 | - | 65 | 174 | 35,5 | 35,5 | 82,4 | 13,8 | GG-30 |
| 64.0224.06 | 224 | 6 | 7 ● | 3525 | 35-100 | 233,5 | 161,5 | - | 65 | 174 | 48,25 | 48,25 | 98,6 | 16,5 | GG-30 |
| 64.0224.08 | 224 | 8 | 7 ● | 3525 | 35-100 | 233,5 | 212,5 | - | 65 | 174 | 73,75 | 73,75 | 132,0 | 22,1 | GG-30 |
| 54.0236.03 | 236 | 3 | 8 ▲ | 3020 | 25-75 | 245,5 | 85 | 125,5 | 51 | 191 | 17,0 | 17,0 | 35,9 | 5,7 | GGG 60 |
| 64.0236.04 | 236 | 4 | 7 ● | 3525 | 35-100 | 245,5 | 110,5 | - | 65 | 186 | 22,75 | 22,75 | 93,8 | 14,9 | GG-30 |
| 64.0236.05 | 236 | 5 | 7 ● | 3525 | 35-100 | 245,5 | 136 | - | 65 | 186 | 35,5 | 35,5 | 105,7 | 16,8 | GG-30 |
| 64.0236.06 | 236 | 6 | 7 ● | 3525 | 35-100 | 245,5 | 161,5 | - | 65 | 186 | 48,25 | 48,25 | 117,1 | 18,6 | GG-30 |
| 64.0236.08 | 236 | 8 | 7 ● | 3525 | 35-100 | 245,5 | 212,5 | - | 65 | 186 | 73,75 | 73,75 | 142,9 | 22,7 | GG-30 |
| 54.0250.03 | 250 | 3 | 8 ▲ | 3020 | 25-75 | 259,5 | 85 | 125,5 | 51 | 207 | 17,0 | 17,0 | 40,7 | 6,1 | GGG 60 |
| 54.0250.04 | 250 | 4 | 8 ▲ | 3525 | 35-100 | 259,5 | 110,5 | 150 | 65 | 207 | 22,75 | 22,75 | 59,3 | 8,9 | GGG 60 |
| 54.0250.05 | 250 | 5 | 8 ▲ | 3525 | 35-100 | 259,5 | 136 | 150 | 65 | 207 | 35,5 | 35,5 | 69,3 | 10,4 | GGG 60 |
| 54.0250.06 | 250 | 6 | 8 ▲ | 3525 | 35-100 | 259,5 | 161,5 | 150 | 65 | 207 | 48,25 | 48,25 | 80,0 | 12,0 | GGG 60 |
| 54.0250.08 | 250 | 8 | 8 ▲ | 3525 | 35-100 | 259,5 | 212,5 | 150 | 65 | 207 | 73,75 | 73,75 | 101,3 | 15,2 | GGG 60 |
| 54.0265.03 | 265 | 3 | 5 ▲ | 3525 | 35-100 | 274,5 | 85 | 150 | 65 | 223 | 20,0 | - | 57,2 | 8,1 | GGG 60 |
| 54.0265.04 | 265 | 4 | 8 ▲ | 3525 | 35-100 | 274,5 | 110,5 | 150 | 65 | 223 | 22,75 | 22,75 | 70,7 | 10,0 | GGG 60 |
| 54.0265.05 | 265 | 5 | 8 ▲ | 3525 | 35-100 | 274,5 | 136 | 150 | 65 | 223 | 35,5 | 35,5 | 79,1 | 11,2 | GGG 60 |
| 54.0265.06 | 265 | 6 | 8 ▲ | 3525 | 35-100 | 274,5 | 161,5 | 150 | 65 | 223 | 48,25 | 48,25 | 90,5 | 12,8 | GGG 60 |
| 54.0265.08 | 265 | 8 | 8 ▲ | 3525 | 35-100 | 274,5 | 212,5 | 150 | 65 | 223 | 73,75 | 73,75 | 112,9 | 17,0 | GGG 60 |
| 54.0280.03 | 280 | 3 | 5 ▲ | 3525 | 35-100 | 289,5 | 85 | 150 | 65 | 238 | 20,0 | - | 63,5 | 8,5 | GGG 60 |
| 54.0280.04 | 280 | 4 | 8 ▲ | 3525 | 35-100 | 289,5 | 110,5 | 150 | 65 | 238 | 22,75 | 22,75 | 75,4 | 10,1 | GGG 60 |
| 54.0280.05 | 280 | 5 | 8 ▲ | 3525 | 35-100 | 289,5 | 136 | 150 | 65 | 238 | 35,5 | 35,5 | 89,6 | 12,0 | GGG 60 |
| 54.0280.06 | 280 | 6 | 8 ▲ | 3525 | 35-100 | 289,5 | 161,5 | 150 | 65 | 238 | 48,25 | 48,25 | 104,5 | 14,0 | GGG 60 |
| 54.0280.08 | 280 | 8 | 8 ▲ | 3525 | 35-100 | 289,5 | 212,5 | 150 | 65 | 238 | 73,75 | 73,75 | 132,2 | 17,7 | GGG 60 |
| 54.0300.03 | 300 | 3 | 8 ▲ | 3525 | 35-100 | 309,5 | 85 | 150 | 65 | 258 | 10,0 | 10,0 | 73,6 | 9,2 | GGG 60 |
| 54.0300.04 | 300 | 4 | 8 ▲ | 3525 | 35-100 | 309,5 | 110,5 | 150 | 65 | 258 | 22,75 | 22,75 | 88,8 | 11,1 | GGG 60 |
| 54.0300.05 | 300 | 5 | 8 ▲ | 3525 | 35-100 | 309,5 | 136 | 150 | 65 | 258 | 35,5 | 35,5 | 103,2 | 12,9 | GGG 60 |
| 54.0300.06 | 300 | 6 | 8 ▲ | 3525 | 35-100 | 309,5 | 161,5 | 150 | 65 | 258 | 48,25 | 48,25 | 121,6 | 15,2 | GGG 60 |
| 54.0300.08 | 300 | 8 | 8 ▲ | 3525 | 35-100 | 309,5 | 212,5 | 150 | 65 | 258 | 73,75 | 73,75 | 146,8 | 18,2 | GGG 60 |
| 54.0315.03 | 315 | 3 | 8 ▲ | 3525 | 35-100 | 324,5 | 85 | 150 | 65 | 273 | 10,0 | 10,0 | 81,5 | 9,7 | GGG 60 |
| 54.0315.04 | 315 | 4 | 8 ▲ | 3525 | 35-100 | 324,5 | 110,5 | 150 | 65 | 273 | 22,75 | 22,75 | 97,4 | 11,6 | GGG 60 |
| 54.0315.05 | 315 | 5 | 8 ▲ | 3525 | 35-100 | 324,5 | 136 | 150 | 65 | 273 | 35,5 | 35,5 | 114,2 | 13,6 | GGG 60 |
| 54.0315.06 | 315 | 6 | 8 ▲ | 3525 | 35-100 | 324,5 | 161,5 | 150 | 65 | 273 | 48,25 | 48,25 | 127,8 | 15,7 | GGG 60 |
| 54.0315.08 | 315 | 8 | 8 ▲ | 3525 | 35-100 | 324,5 | 212,5 | 150 | 65 | 273 | 73,75 | 73,75 | 172,2 | 20,5 | GGG 60 |

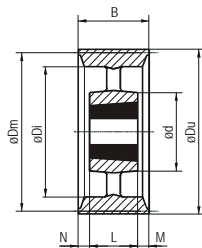

Type 8

| Code | Dm | Grooves Spør | Pulley Skive | Bush Bøsn. | Bore Udboring | Du | B | d | L | Di | M | N | Unbalance Ubalance | Weight Vægt | Matr. |
|------------|-----|-----------------|-----------------|---------------|------------------|-------|-------|-----|----|-----|-------|-------|-----------------------|----------------|------------|
| EDB | mm | no./antal | type | type | mm | mm | mm | mm | mm | mm | mm | mm | gcm (max) | kg | DIN1691/93 |
| 54.0335.03 | 335 | 3 | 8 ▲ | 3525 | 35-100 | 344,5 | 85 | 150 | 65 | 290 | 10,0 | 10,0 | 103,6 | 11,6 | GGG 60 |
| 54.0335.04 | 335 | 4 | 8 ▲ | 3525 | 35-100 | 344,5 | 110,5 | 150 | 65 | 290 | 22,75 | 22,75 | 109,9 | 13,0 | GGG 60 |
| 54.0335.05 | 335 | 5 | 8 ▲ | 3525 | 35-100 | 344,5 | 136 | 150 | 65 | 290 | 35,5 | 35,5 | 134,0 | 15,0 | GGG 60 |
| 54.0335.06 | 335 | 6 | 8 ▲ | 3525 | 35-100 | 344,5 | 161,5 | 150 | 65 | 290 | 48,25 | 48,25 | 157,2 | 17,6 | GGG 60 |
| 54.0335.08 | 335 | 8 | 8 ▲ | 3525 | 35-100 | 344,5 | 212,5 | 150 | 65 | 290 | 73,75 | 73,75 | 209,9 | 23,5 | GGG 60 |
| 54.0355.03 | 355 | 3 | 8 ▲ | 3525 | 35-100 | 364,5 | 85 | 150 | 65 | 310 | 10,0 | 10,0 | 99,5 | 11,4 | GGG 60 |
| 54.0355.04 | 355 | 4 | 8 ▲ | 3525 | 35-100 | 364,5 | 110,5 | 150 | 65 | 310 | 22,75 | 22,75 | 129,7 | 13,7 | GGG 60 |
| 54.0355.05 | 355 | 5 | 8 ▲ | 3525 | 35-100 | 364,5 | 136 | 150 | 65 | 310 | 35,5 | 35,5 | 150,5 | 15,9 | GGG 60 |
| 54.0355.06 | 355 | 6 | 8 ▲ | 3525 | 35-100 | 364,5 | 161,5 | 150 | 65 | 310 | 48,25 | 48,25 | 172,3 | 18,2 | GGG 60 |
| 54.0355.08 | 355 | 8 | 8 ▲ | 3525 | 35-100 | 364,5 | 212,5 | 150 | 65 | 310 | 73,75 | 73,75 | 207,8 | 23,1 | GGG 60 |
| 54.0375.03 | 375 | 3 | 8 ▲ | 3525 | 35-100 | 384,5 | 85 | 150 | 65 | 329 | 10,0 | 10,0 | 123,0 | 12,3 | GGG 60 |
| 54.0375.04 | 375 | 4 | 8 ▲ | 3525 | 35-100 | 384,5 | 110,5 | 150 | 65 | 329 | 22,75 | 22,75 | 136,6 | 14,5 | GGG 60 |
| 54.0375.05 | 375 | 5 | 8 ▲ | 3525 | 35-100 | 384,5 | 136 | 150 | 65 | 329 | 35,5 | 35,5 | 162,1 | 16,7 | GGG 60 |
| 54.0375.06 | 375 | 6 | 8 ▲ | 3525 | 35-100 | 384,5 | 161,5 | 150 | 65 | 329 | 48,25 | 48,25 | 194,0 | 19,4 | GGG 60 |
| 54.0375.08 | 375 | 8 | 8 ▲ | 4030 | 40-115 | 384,5 | 212,5 | 176 | 76 | 329 | 68,25 | 68,25 | 268,0 | 26,4 | GGG 60 |
| 54.0400.03 | 400 | 3 | 8 ▲ | 3525 | 35-100 | 409,5 | 85 | 150 | 65 | 354 | 10,0 | 10,0 | 133,3 | 13,2 | GGG 60 |
| 54.0400.04 | 400 | 4 | 8 ▲ | 3525 | 35-100 | 409,5 | 110,5 | 150 | 65 | 354 | 22,75 | 22,75 | 156,8 | 16,0 | GGG 60 |
| 54.0400.05 | 400 | 5 | 8 ▲ | 3525 | 35-100 | 409,5 | 136 | 150 | 65 | 354 | 35,5 | 35,5 | 180,3 | 18,5 | GGG 60 |
| 54.0400.06 | 400 | 6 | 8 ▲ | 3525 | 35-100 | 409,5 | 161,5 | 150 | 65 | 354 | 48,25 | 48,25 | 228,3 | 21,4 | GGG 60 |
| 54.0400.08 | 400 | 8 | 8 ▲ | 4030 | 40-115 | 409,5 | 212,5 | 176 | 76 | 354 | 68,25 | 68,25 | 295,5 | 29,3 | GGG 60 |
| 54.0425.03 | 425 | 3 | 8 ▲ | 3525 | 35-100 | 434,5 | 85 | 150 | 65 | 375 | 10,0 | 10,0 | 154,1 | 13,6 | GGG 60 |
| 54.0425.04 | 425 | 4 | 8 ▲ | 3525 | 35-100 | 434,5 | 110,5 | 150 | 65 | 375 | 22,75 | 22,75 | 185,9 | 16,4 | GGG 60 |
| 54.0425.05 | 425 | 5 | 8 ▲ | 3525 | 35-100 | 434,5 | 136 | 150 | 65 | 378 | 35,5 | 35,5 | 230,1 | 20,3 | GGG 60 |
| 54.0425.06 | 425 | 6 | 8 ▲ | 4535 | 55-125 | 434,5 | 161,5 | 198 | 89 | 375 | 36,25 | 36,25 | 250,5 | 30,6 | GGG 60 |
| 54.0425.08 | 425 | 8 | 8 ▲ | 4535 | 55-125 | 434,5 | 212,5 | 198 | 89 | 375 | 61,75 | 61,75 | 371,7 | 32,8 | GGG 60 |
| 54.0450.03 | 450 | 3 | 8 ▲ | 3525 | 35-100 | 459,5 | 85 | 150 | 65 | 403 | 10,0 | 10,0 | 194,4 | 16,2 | GGG 60 |
| 54.0450.04 | 450 | 4 | 8 ▲ | 3525 | 35-100 | 459,5 | 110,5 | 150 | 65 | 403 | 22,75 | 22,75 | 235,2 | 19,6 | GGG 60 |
| 54.0450.05 | 450 | 5 | 8 ▲ | 3525 | 35-100 | 459,5 | 136 | 150 | 65 | 403 | 35,5 | 35,5 | 277,2 | 23,1 | GGG 60 |
| 54.0450.06 | 450 | 6 | 8 ▲ | 4535 | 55-125 | 459,5 | 161,5 | 198 | 89 | 403 | 36,25 | 36,25 | 367,2 | 30,6 | GGG 60 |
| 54.0450.08 | 450 | 8 | 8 ▲ | 4535 | 55-125 | 459,5 | 212,5 | 198 | 89 | 403 | 61,75 | 61,75 | 442,8 | 36,9 | GGG 60 |
| 54.0475.03 | 475 | 3 | 8 ▲ | 3525 | 35-100 | 484,5 | 85 | 150 | 65 | 426 | 10,0 | 10,0 | 207,7 | 16,4 | GGG 60 |
| 54.0475.04 | 475 | 4 | 8 ▲ | 3525 | 35-100 | 484,5 | 110,5 | 150 | 65 | 426 | 22,75 | 22,75 | 254,6 | 20,1 | GGG 60 |
| 54.0475.05 | 475 | 5 | 8 ▲ | 3525 | 35-100 | 484,5 | 136 | 150 | 65 | 426 | 35,5 | 35,5 | 309,1 | 24,4 | GGG 60 |
| 54.0475.06 | 475 | 6 | 8 ▲ | 4535 | 55-125 | 484,5 | 161,5 | 198 | 89 | 426 | 36,25 | 36,25 | 411,7 | 32,5 | GGG 60 |
| 54.0475.08 | 475 | 8 | 8 ▲ | 4535 | 55-125 | 484,5 | 212,5 | 198 | 89 | 426 | 61,75 | 61,75 | 501,6 | 39,6 | GGG 60 |
| 54.0500.03 | 500 | 3 | 8 ▲ | 3525 | 35-100 | 509,5 | 85 | 150 | 65 | 453 | 10,0 | 10,0 | 237,3 | 17,8 | GGG 60 |
| 54.0500.04 | 500 | 4 | 8 ▲ | 3525 | 35-100 | 509,5 | 110,5 | 150 | 65 | 453 | 22,75 | 22,75 | 289,3 | 21,7 | GGG 60 |
| 54.0500.05 | 500 | 5 | 8 ▲ | 3525 | 35-100 | 509,5 | 136 | 150 | 65 | 453 | 35,5 | 35,5 | 349,3 | 26,2 | GGG 60 |
| 54.0500.06 | 500 | 6 | 8 ▲ | 4535 | 55-125 | 509,5 | 161,5 | 198 | 89 | 453 | 36,25 | 36,25 | 456,0 | 34,2 | GGG 60 |
| 54.0500.08 | 500 | 8 | 8 ▲ | 4535 | 55-125 | 509,5 | 212,5 | 198 | 89 | 450 | 61,75 | 61,75 | 569,3 | 42,7 | GGG 60 |
| 54.0530.03 | 530 | 3 | 8 ▲ | 3525 | 35-100 | 539,5 | 85 | 150 | 65 | 483 | 10,0 | 10,0 | 265,7 | 18,8 | GGG 60 |
| 54.0530.04 | 530 | 4 | 8 ▲ | 3525 | 35-100 | 539,5 | 110,5 | 150 | 65 | 483 | 22,75 | 22,75 | 318,0 | 22,5 | GGG 60 |
| 54.0530.05 | 530 | 5 | 8 ▲ | 4535 | 55-125 | 539,5 | 136 | 198 | 89 | 483 | 23,5 | 23,5 | 438,1 | 31,0 | GGG 60 |
| 54.0530.06 | 530 | 6 | 8 ▲ | 4535 | 55-125 | 539,5 | 161,5 | 198 | 89 | 480 | 36,25 | 36,25 | 509,6 | 37,0 | GGG 60 |
| 54.0530.08 | 530 | 8 | 8 ▲ | 4535 | 55-125 | 539,5 | 212,5 | 198 | 89 | 480 | 61,75 | 61,75 | 636,0 | 45,0 | GGG 60 |

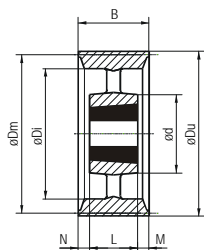

Type 8

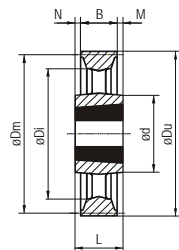

Type 9

| Code | Dm | Grooves Spor | Pulley Skive | Bush Bøsn. | Bore Udboring | Du | B | d | L | Di | M | N | Unbalance Ubalance | Weight Vægt | Matr. |
|------------|------|-----------------|-----------------|---------------|------------------|--------|-------|-----|-----|------|-------|-------|-----------------------|----------------|------------|
| EDB | mm | no./antal | type | type | mm | mm | mm | mm | mm | mm | mm | mm | gcm (max) | kg | DIN1691/93 |
| 54.0560.03 | 560 | 3 | 8 ▲ | 3525 | 35-100 | 569,5 | 85 | 150 | 65 | 509 | 10,0 | 10,0 | 334,5 | 22,4 | GGG 60 |
| 54.0560.04 | 560 | 4 | 8 ▲ | 3525 | 35-100 | 569,5 | 110,5 | 150 | 65 | 510 | 22,75 | 22,75 | 371,8 | 25,3 | GGG 60 |
| 54.0560.05 | 560 | 5 | 8 ▲ | 4535 | 55-125 | 569,5 | 136 | 198 | 89 | 509 | 23,5 | 23,5 | 542,1 | 36,3 | GGG 60 |
| 54.0560.06 | 560 | 6 | 8 ▲ | 4535 | 55-125 | 569,5 | 161,5 | 198 | 89 | 509 | 36,25 | 36,25 | 594,3 | 39,8 | GGG 60 |
| 54.0560.08 | 560 | 8 | 8 ▲ | 4535 | 55-125 | 569,5 | 212,5 | 198 | 89 | 509 | 61,75 | 61,75 | 761,6 | 51,0 | GGG 60 |
| 54.0630.03 | 630 | 3 | 8 ▲ | 4030 | 40-115 | 639,5 | 85 | 176 | 76 | 580 | 4,5 | 4,5 | 431,4 | 27,6 | GGG 60 |
| 54.0630.04 | 630 | 4 | 8 ▲ | 4030 | 40-115 | 639,5 | 110,5 | 176 | 76 | 580 | 17,25 | 17,25 | 506,0 | 31,8 | GGG 60 |
| 54.0630.05 | 630 | 5 | 8 ▲ | 4535 | 55-125 | 639,5 | 136 | 198 | 89 | 580 | 23,5 | 23,5 | 652,2 | 40,0 | GGG 60 |
| 54.0630.06 | 630 | 6 | 8 ▲ | 4535 | 55-125 | 639,5 | 161,5 | 198 | 89 | 579 | 36,25 | 36,25 | 794,6 | 47,0 | GGG 60 |
| 54.0630.08 | 630 | 8 | 8 ▲ | 4535 | 55-125 | 639,5 | 212,5 | 198 | 89 | 580 | 61,75 | 61,75 | 933,4 | 55,1 | GGG 60 |
| 54.0710.03 | 710 | 3 | 8 ▲ | 4030 | 40-115 | 719,5 | 85 | 176 | 76 | 660 | 4,5 | 4,5 | 573,7 | 30,3 | GGG 60 |
| 54.0710.04 | 710 | 4 | 8 ▲ | 4030 | 40-115 | 719,5 | 110,5 | 176 | 76 | 660 | 17,25 | 17,25 | 679,3 | 54,0 | GGG 60 |
| 54.0710.05 | 710 | 5 | 8 ▲ | 5040 | 70-125 | 719,5 | 136 | 218 | 102 | 660 | 17,0 | 17,0 | 931,5 | 64,0 | GGG 60 |
| 54.0710.06 | 710 | 6 | 8 ▲ | 5040 | 70-125 | 719,5 | 161,5 | 218 | 102 | 660 | 29,75 | 29,75 | 1050,8 | 68,5 | GGG 60 |
| 54.0710.08 | 710 | 8 | 8 ▲ | 5040 | 70-125 | 719,5 | 212,5 | 218 | 102 | 659 | 55,25 | 55,25 | 1420,0 | 49,2 | GGG 60 |
| 54.0800.03 | 800 | 3 | 9 ▲ | 4535 | 55-125 | 809,5 | 85 | 198 | 89 | 750 | 2,0 | 2,0 | 797,4 | 52,0 | GGG 60 |
| 54.0800.04 | 800 | 4 | 8 ▲ | 5040 | 70-125 | 809,5 | 110,5 | 218 | 102 | 750 | 4,25 | 4,25 | 1007,4 | 47,2 | GGG 60 |
| 54.0800.05 | 800 | 5 | 8 ▲ | 5040 | 70-125 | 809,5 | 136 | 218 | 102 | 750 | 17,0 | 17,0 | 1193,0 | 63,0 | GGG 60 |
| 54.0800.06 | 800 | 6 | 8 ▲ | 5040 | 70-125 | 809,5 | 161,5 | 218 | 102 | 750 | 29,75 | 29,75 | 1372,2 | 67,0 | GGG 60 |
| 54.0800.08 | 800 | 8 | 8 ▲ | 5040 | 70-125 | 809,5 | 212,5 | 218 | 102 | 750 | 55,25 | 55,25 | 1747,2 | 77,5 | GGG 60 |
| 54.1000.03 | 1000 | 3 | 9 ▲ | 5040 | 70-125 | 1009,5 | 85 | 218 | 102 | 937 | 8,5 | 8,5 | 2014,4 | 75,5 | GGG 60 |
| 54.1000.04 | 1000 | 4 | 8 ▲ | 5040 | 70-125 | 1009,5 | 110,5 | 218 | 102 | 937 | 4,25 | 4,25 | 2446,4 | 79,0 | GGG 60 |
| 54.1000.05 | 1000 | 5 | 8 ▲ | 5040 | 70-125 | 1009,5 | 136 | 218 | 102 | 937 | 17,0 | 17,0 | 2814,4 | 86,0 | GGG 60 |
| 54.1000.06 | 1000 | 6 | 8 ▲ | 5040 | 70-125 | 1009,5 | 161,5 | 218 | 102 | 937 | 29,75 | 29,75 | 2974,4 | 96,0 | GGG 60 |
| 54.1000.08 | 1000 | 8 | 8 ▲ | 5040 | 70-125 | 1009,5 | 212,5 | 218 | 102 | 937 | 55,25 | 55,25 | 3358,4 | 103,0 | GGG 60 |
| 54.1250.03 | 1250 | 3 | 9 ▲ | 5040 | 70-125 | 1259,5 | 85 | 218 | 102 | 1187 | 8,5 | 8,5 | 3258,0 | 97,7 | GGG 60 |
| 54.1250.04 | 1250 | 4 | 8 ▲ | 5040 | 70-125 | 1259,5 | 110,5 | 218 | 102 | 1187 | 4,25 | 4,25 | 4038,0 | 121,1 | GGG 60 |
| 54.1250.05 | 1250 | 5 | 8 ▲ | 5040 | 70-125 | 1259,5 | 136 | 218 | 102 | 1187 | 17,0 | 17,0 | 4678,0 | 140,3 | GGG 60 |
| 54.1250.06 | 1250 | 6 | 8 ▲ | 5040 | 70-125 | 1259,5 | 161,5 | 218 | 102 | 1187 | 29,75 | 29,75 | 5118,0 | 153,5 | GGG 60 |
| 54.1250.08 | 1250 | 8 | 8 ▲ | 5040 | 70-125 | 1259,5 | 212,5 | 218 | 102 | 1187 | 55,25 | 55,25 | 5478,0 | 149,0 | GGG 60 |

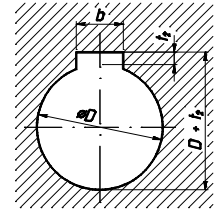
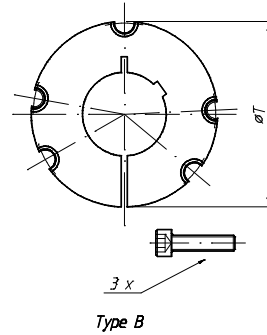
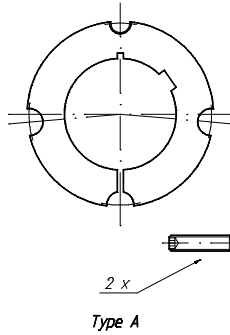

| D | b | t ₂ | * | Size / størrelse | | | | | | | | | | | | | | | |
|-------------------|--------|----------------|-----|------------------|----------|----------|----------|----------|----------|----------|----------|----------|----------|----------|----------|----------|----------|----------|------|
| | | | | 1008 | 1108 | 1210 | 1610 | 2012 | 2517 | 3020 | 3030 | 3525 | 3535 | 4030 | 4040 | 4535 | 4545 | 5040 | 5050 |
| 9 | 3 | 1,4 | - | M | M | | | | | | | | | | | | | | |
| 10 | 3 | 1,4 | - | M | M | | | | | | | | | | | | | | |
| 11 | 4 | 1,8 | - | M | M | M | | | | | | | | | | | | | |
| 12 | 4 | 1,8 | - | M | M | M | M | | | | | | | | | | | | |
| 14 | 5 | 2,3 | - | M | M | M | M | M | | | | | | | | | | | |
| 16 | 5 | 2,3 | - | M | M | M | M | M | M | | | | | | | | | | |
| 18 | 6 | 2,8 | - | M | M | M | M | M | M | | | | | | | | | | |
| 19 | 6 | 2,8 | - | M | M | M | M | M | M | | | | | | | | | | |
| 20 | 6 | 2,8 | - | M | M | M | M | M | M | | | | | | | | | | |
| 22 | 6 | 3,3 | - | M | M | M | M | M | M | | | | | | | | | | |
| 24 | 8 | 3,3 | 1,3 | M* | M | M | M | M | M | | | | | | | | | | |
| 25 | 8 | 3,3 | 1,3 | M* | M | M | M | M | M | M | | | | | | | | | |
| 28 | 8 | 3,3 | 1,3 | | M* | M | M | M | M | M | | | | | | | | | |
| 30 | 8 | 3,3 | - | | | M | M | M | M | M | | | | | | | | | |
| 32 | 10 | 3,3 | - | | | M | M | M | M | M | | | | | | | | | |
| 35 | 10 | 3,3 | - | | | | M | M | M | M | M | M | | | | | | | |
| 38 | 10 | 3,3 | - | | | | M | M | M | M | M | M | M | | | | | | |
| 40 | 12 | 3,3 | 1,3 | | | | M* | M | M | M | M | M | M | M | M | | | | |
| 42 | 12 | 3,3 | 1,3 | | | | M* | M | M | M | M | M | M | M | M | | | | |
| 45 | 14 | 3,8 | - | | | | | M | M | M | M | M | M | M | M | | | | |
| 48 | 14 | 3,8 | - | | | | | M | M | M | M | M | M | M | M | | | | |
| 50 | 14 | 3,8 | - | | | | | M | M | M | M | M | M | M | M | | | | |
| 55 | 16 | 4,3 | - | | | | | | M | M | M | M | M | M | M | M | M | | |
| 60 | 18 | 4,4 | - | | | | | | M | M | M | M | M | M | M | M | M | | |
| 65 | 18 | 4,4 | - | | | | | | | M | M | M | M | M | M | M | M | | |
| 70 | 20 | 4,9 | - | | | | | | | M | M | M | M | M | M | M | M | M | |
| 75 | 20 | 4,9 | - | | | | | | | M | M | M | M | M | M | M | M | M | |
| 80 | 22 | 5,4 | - | | | | | | | | M | M | M | M | M | M | M | M | |
| 85 | 22 | 5,4 | - | | | | | | | | M | M | M | M | M | M | M | M | |
| 90 | 25 | 5,4 | 3,4 | | | | | | | | | M | M* | M | M | M | M | M | |
| 95 | 25 | 5,4 | - | | | | | | | | | M | | M | M | M | M | M | |
| 100 | 28 | 6,4 | 4,4 | | | | | | | | | M* | | M | M* | M | M | M | |
| 105 | 28 | 6,4 | - | | | | | | | | | | | M | | M | M | M | |
| 110 | 28 | 6,4 | - | | | | | | | | | | | M | | M | M | M | |
| 115 | 32 | 7,4 | 5,4 | | | | | | | | | | | M* | | M | | M | |
| 120 | 32 | 7,4 | - | | | | | | | | | | | | | M | | M | |
| 125 | 32 | 7,4 | - | | | | | | | | | | | | | M | | M | |
| TYPE | | | | A | A | A | A | A | A | A | A | B | B | B | B | B | B | B | |
| T | mm | | | 35,0 | 38,0 | 47,5 | 57,0 | 70,0 | 85,5 | 108,0 | 108,0 | 127,0 | 127,0 | 146,0 | 146,0 | 162,0 | 162,0 | 177,5 | |
| Appr. weight/vægt | kg | | | 0,1 | 0,1 | 0,2 | 0,3 | 0,7 | 1,5 | 2,7 | 3,4 | 3,8 | 5,7 | 5,6 | 8,4 | 7,5 | 10,4 | 11,1 | |
| Screws / Skruer | B.S.W. | | | ¼" | ¼" | d" | d" | 7/16" | ½" | e" | e" | ½" | ½" | e" | e" | ¾" | ¾" | f" | |
| | | | | x | x | x | x | x | x | x | x | x | x | x | x | x | x | x | x |
| | | | | ½" | ½" | e" | e" | f" | 1" | 1¼" | 1¼" | 1½" | 1½" | 1¾" | 1¾" | 2" | 2" | 2¼" | |

*Bush with reduced height for keyway / Dybde af notgang er under standardmål



SPOR DIMENSIONER / GROOVE DIMENSIONS

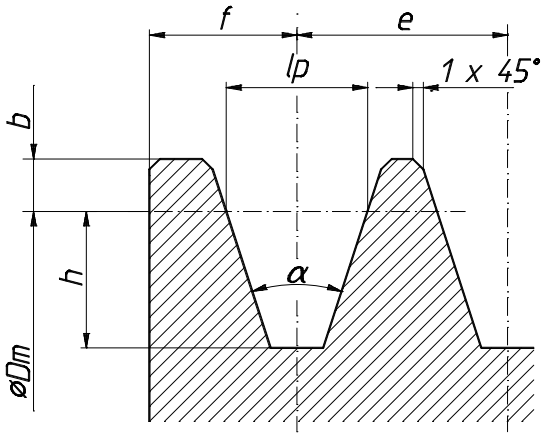

| | Dm mm | ang. | lp mm | h mm | b mm | f mm | e mm |
|-----|------------|------|----------|---------|---------|---------|---------|
| SPZ | ≤ 80 | 34° | 8,5 | 9 | 2 | 8 | 12 |
| | > 80 | 38° | | | | | |
| SPA | ≤ 118 | 34° | 11 | 11 | 2,75 | 10 | 15 |
| | > 118 | 38° | | | | | |
| SPB | ≤ 190 | 34° | 14 | 14 | 3,5 | 12,5 | 19 |
| | > 190 | 38° | | | | | |
| SPC | ≤ 315 | 34° | 19 | 19 | 4,75 | 17 | 25,5 |
| | > 315 | 38° | | | | | |

ISO 4183 - 1983

MATERIAL

All cast iron used for the Taper Bush pulleys is electrically melted quality cast iron. This gives the iron an increased degree of purity and quality. Electrically melted iron contains only a minimum of contaminating matters as e. g. phosphor and sulphur.

Therefore it has a very close-grained structure without microporosities. Because of the high degree of purity gas holes in the cast iron are avoided.

MATERIALE

Alt støbegods, der er anvendt til Taper Bush kileremskiver, er elektrosmeltet kvalitetsstøbejern. Dette giver jernet en større renhed og højere kvalitet. Elektrosmeltet jern indeholder kun minimale mængder af forureninger bl. a. fosfor og svovl.

Det har derfor en meget tæt struktur uden mikroporositeter, og på grund af den høje renhedsgrad undgås gashuller i godset.

BALANCING

Taper Bush pulleys are supplied with a max. static unbalance, balanced in one plane, according to quality grade G16 ¹⁾. Upon request the pulleys can be supplied balanced in two planes, dynamic unbalance, according to quality grade G16 or G6,3.

¹⁾ Designation according to ISO 1940

AFBALANCERING

Taper Bush kileremskiver leveres med en max. ubalance i et plan, kvalitetsgrad G16 ¹⁾. Efter ønske kan kileremskiver leveres afbalanceret i to planer, kvalitetsgrad G16 eller G6,3.

¹⁾ Betegnelse i henhold til ISO 1940

PACKING

Taper Bush pulleys are zincphosphated and oiled. They are not separately packed. Taper-bushings are packed in cardboard boxes together with screws and mounting instructions.

EMBALLAGE

Taper Bush kileremskiver er zinkfosfaterede med en efter følgende oliering. De er ikke særskilt emballeret. Bøsninger er emballeret i en papæske med skruer og monteringsvejledning.