

MATO

Conveyor Belt Cleaner Products

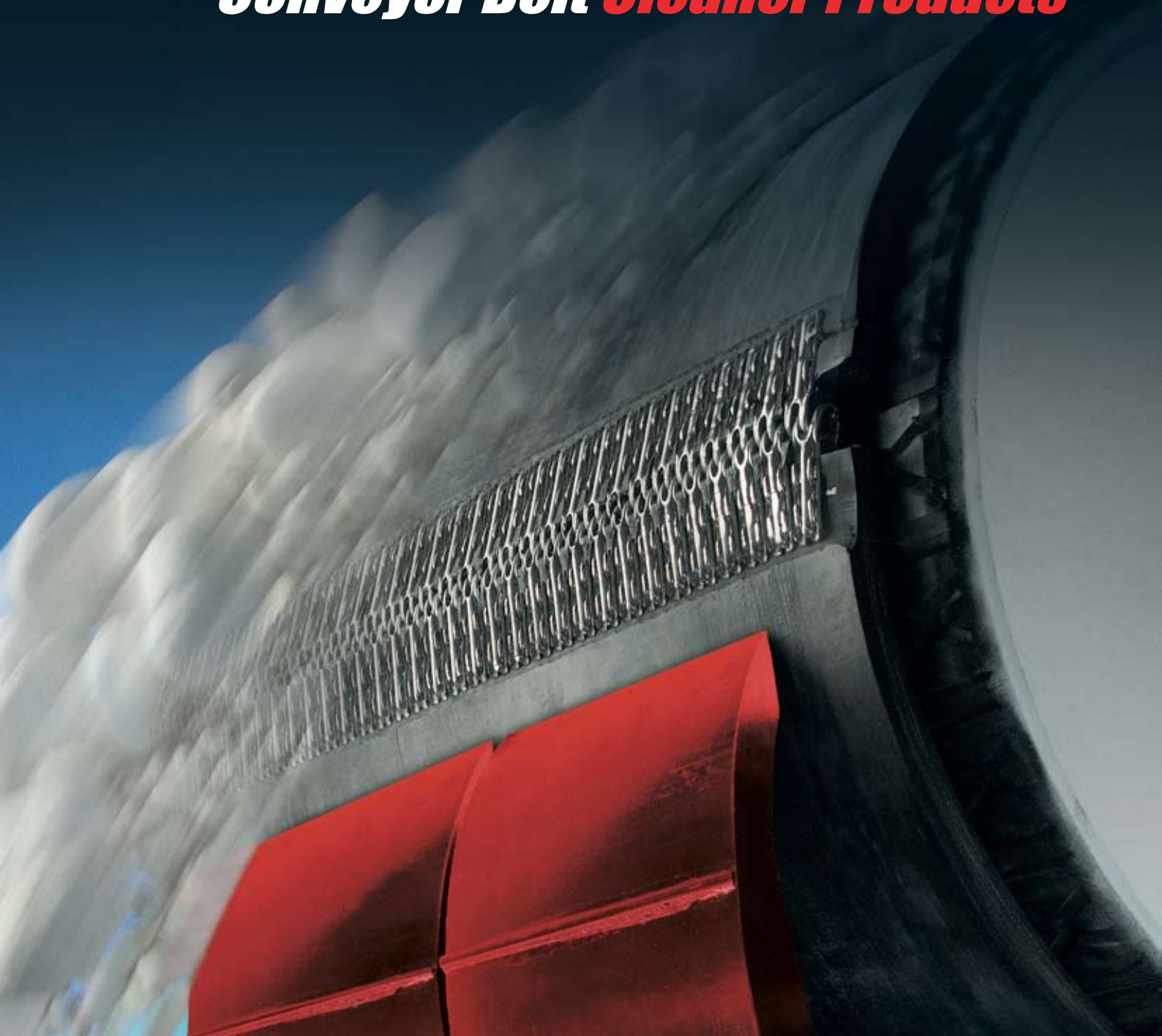

Company Profile



MATO Australia Pty Ltd was formed in 1990 as a joint venture between the Australian Managing Director and MATO Germany to service the Australasian, South Pacific and South East Asian regions.

MATO Australia is predominately a provider of conveyor belt fastening and maintenance systems into the mining industries.

The product range includes:

- Belt Lacing Systems
- Belt Cleaner Systems
- Ultrasonics & Control Units
- Belt Tracking Products
- Skirts & Guards
- Belt Clamps

Origins

MATO GmbH was founded in Germany in 1906, starting life as a manufacturer of metalware and hardware. In the years since then, however, it has significantly diversified its product base and advanced to become an acknowledged leader in a variety of different fields, supplying technically advanced products to the world's leading companies. By consistently improving and updating its product ranges, MATO has become a leading player in what is a very tough international marketplace.

World Wide Network

Recognising the need to have global presence through a strong international sales network, MATO established specialised subsidiaries in France, Switzerland, the UK, USA, Spain, South Africa and Australia, offering local customers excellent service and full technical back up. Each of these subsidiaries sell international customers directly or through agents in their regions of the world.

Contents



PRIMARY BELT CLEANERS

| | |
|--------------------------------------|----|
| MCP1 Belt Cleaner | 04 |
| MUP2 Polyurethane Belt Cleaner | 05 |

SECONDARY BELT CLEANERS

| | |
|-------------------------|----|
| MCS1 Belt Cleaner | 06 |
| MUS2 Belt Cleaner | 07 |
| MCS2 Belt Cleaner | 07 |
| MUS3 Belt Cleaner | 08 |
| MCS4 Belt Cleaner | 08 |

RETURNS BELT CLEANERS

| | |
|----------------------------|----|
| MCR1 Vee Plough | 09 |
| MCR2 Diagonal Plough | 09 |
| MUR1 Vee Plough | 09 |

BELT CLEANER ACCESSORIES

| | |
|--------------------------------|----|
| Spring Tension Assembly | 10 |
| Air Bag Tension Assembly | 10 |

DUST SUPPRESSION SYSTEMS

| | |
|-------------------------------------|----|
| In-Line Water Control Unit | 11 |
| Ultrasonic Water Control Unit | 11 |

Primary Belt Cleaners

MCP1 PRE BELT CLEANER

The MATO MCP1 Belt Cleaning Unit is an aggressive head drum cleaner consisting of multiple blade sections, in line, mounted just under the Tangential centre line of the head pulley, to remove the bulk of the carry back material to return to the main flow of product being conveyed. The MCP1 cleaner is mounted underneath the head drum to ensure no material build up occurs on the cleaner unit, and to eliminate the risk of damage from the cleaner to the belt.

Each blade is individually mounted with a rubber tensioning cushion to ensure even blade pressure across the face of the head drum. Tungsten carbide blades are used for fully Vulcanised Belts and Polyurethane Blades are used for mechanically fastened belts.

FEATURES:

- Easy blade replacement
- Outstanding performance on sticky material
- Clog free operation
- Various blade options
- Multi-bladed with individual cushion mounts
- Can operate on reversing belt.



TUNGSTEN CARBIDE BLADES

MATO offers different grades of Tungsten Carbide to suit each application. E.g. Tungsten Impact when used with aggressive products or belts, Tungsten long life for high speed, abrasive, applications (Not for use with mechanical fasteners.)

MUP2 POLYURETHANE BELT CLEANER

The MATO MUP2 Polyurethane Primary Belt Cleaner is designed to be an aggressive but friendly to the conveyor belts surface head drum belt cleaner, returning the bulk of the carry back material to the main stream production flow being conveyed.

The MUP2 Primary Polyurethane Head Cleaner has two standard types of tensioning devices available, 1st is our all in one Tension Spring Assembly & 2nd is our New Air Operated End Assembly for the most reliable and effective tensioning method available in today's market.

The air operated end assembly offers a constant blade pressure to the conveyors belts surface for the entire life of the polyurethane's blade, eliminating continuous blade adjustment and maintenance. Note, if air is not available the air bag end assembly can also be tensioned by using water pressure from a main supply line, See your local MATO representative for more details.

FEATURES:

- Easy blade replacement
- Outstanding performance on sticky material
- Clog free operation
- Various polyurethane blade options
- Multi-bladed
- Suitable for use with mechanical fasteners
- Full Width Blades available by request.

POLYURETHANE BLADES

The MUP2 Cleaner has a multiple of polyurethane grades available to choose from. They can be used in Underground Coal Mines with stringent fire resistant, antistatic requirements, as well as surface applications with aggressive products being conveyed, to high temperature or even food grade applications.

MATO has also recently incorporated a Polyurethane Blade suitable for dry applications with the Polyurethane Blade being used having it's own in built lubrication element to reduce the chances of chattering whilst running on dry conveyor belts.

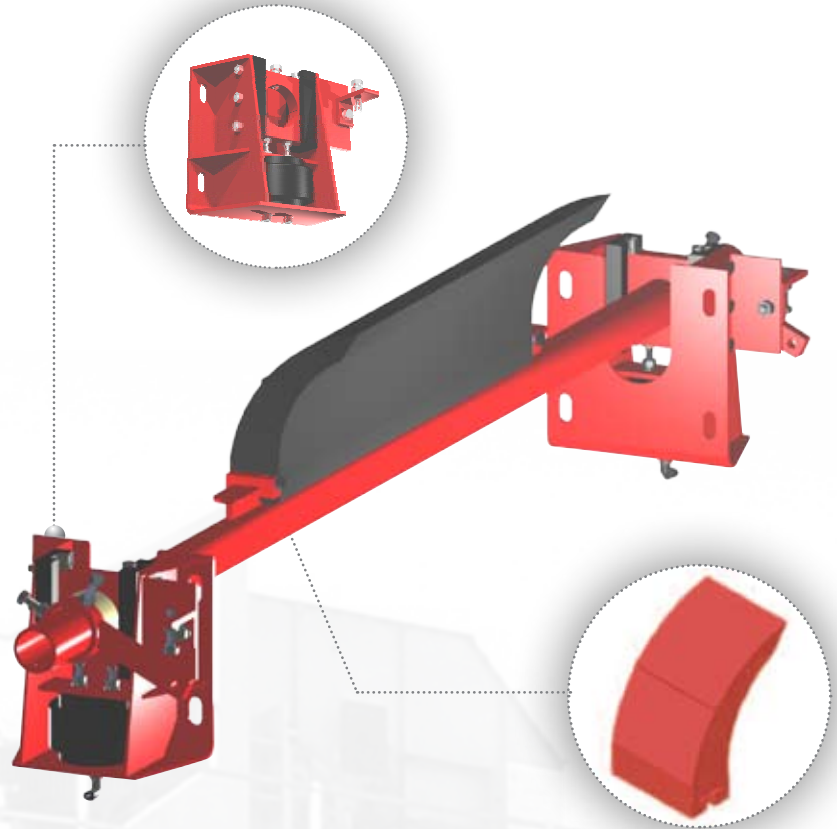

Secondary Belt Cleaners

MCS1 BELT CLEANER

The MATO MCS1 Unique Belt Cleaning System is designed to allow the cleaner blade to act independently to conform to the conveyor belt surface. The Mounting arm arrangement encompassing the Air bag system allows each side of the cleaner to act independently of each other thus providing the even distribution of cleaner blade pressure on the belt while allowing the blade to follow any variation in the belt surface. The Unique concept of the MATO MCS1 Belt Cleaner is such that the cleaner blade is free to move on the belt, while still maintaining relatively constant pressure across its cleaning surface.

FEATURES:

- Easy blade replacement
- Outstanding performance on sticky material
- Clog-free operation
- Various blade options
- Suitable for use with mechanical fasteners

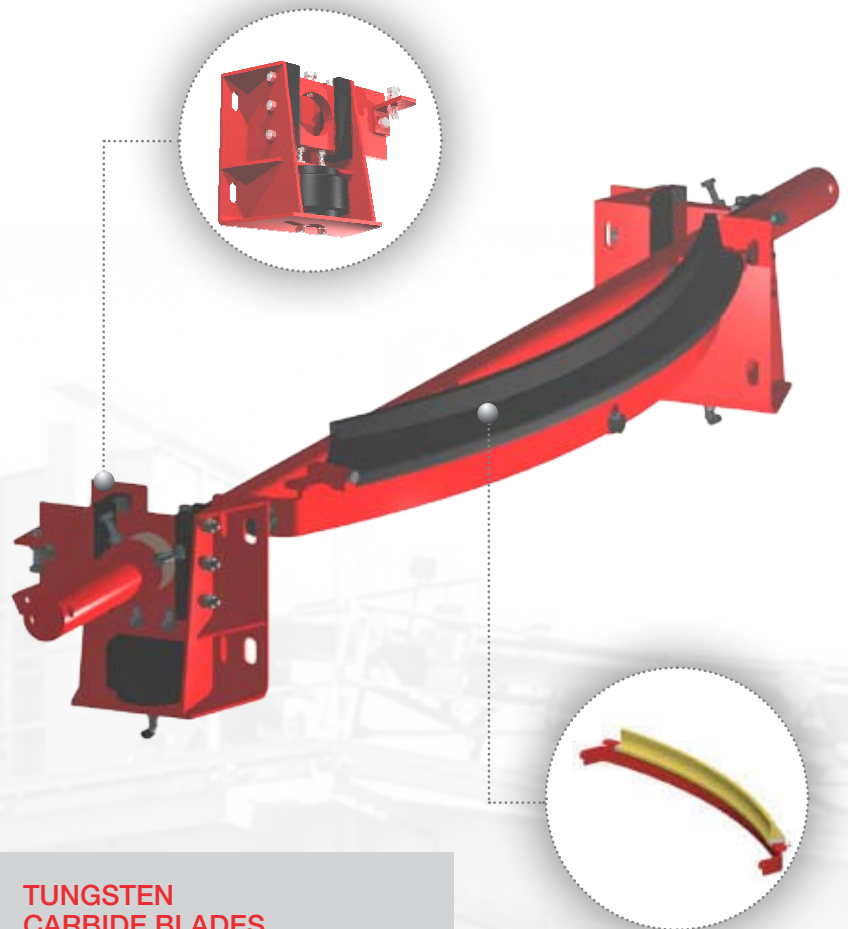

TUNGSTEN CARBIDE BLADES

MATO offers different grades of Tungsten Carbide to suit each application.

E.g. Tungsten Impact where used with mechanical fasteners, Tungsten Long Life for high speed and abrasive fully spliced applications.

MUS2 BELT CLEANER

The MATO MUS2 Belt Cleaner is one of our latest designed belt cleaners; this New belt Cleaner offer's our New M-TRAK slide on cushion & blade for easy installation and maintenance. The unique M-TRAK is designed to eliminate long maintenance down times and insures that all blade alignments are 100% true across the entire conveyor belt width. When using our New Air Tensioned End Assemblies, blade replacement is very simple with the design of the slide on and slide of principle, meaning no special tools or training is required when maintenance is performed.

The unique design of our New MUS2 Cushion is bases on the principle of a parallelogram whereby the cushion also stay's true to the conveyor belts surface and ensures the attacking angle is maintained.

FEATURES

- Outstanding performance
- New M-TRAK design easy replacement & maintenance.
- Easy installation.
- Constant Air bag tensioning device.
- Long blade life.



MCS2 BELT CLEANER

The MATO MCS2 Belt Cleaning Unit is multi-bladed in-line system. Each blade is individually mounted with a rubber tensioning cushion to ensure even blade pressure, and constant tip contact across the belt surface.

FEATURES:

- Fits into confined spaces
- Outstanding performance on sticky material
- Easy installation and maintenance
- Various blade options
- Multi-bladed with individual cushion mounts
- Long blade life

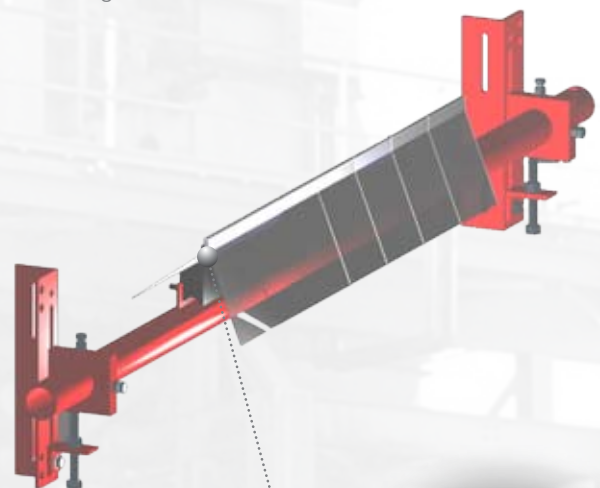

Secondary Belt Cleaners

MUS3 BELT CLEANER

The MATO MUS3 Belt Cleaner is one of our latest designed belt cleaners; this New belt Cleaner offer's our New M-TRAK slide on cushion & blade for easy installation and maintenance. The unique M-TRAK is designed to eliminate long maintenance down times and insures that all blade alignments are 100% true across the entire conveyor belt width. When using our New Air Tensioned End Assemblies, blade replacement is very simple with the design of the slide on and slide of principle, meaning no special tools or training is required when maintenance is performed.

The New MUS3 cleaner is specifically designed to be installed on Conveyor Systems that have either fully spliced or Mechanical belt fasteners, the design of our New MUS3 cleaners has Tungsten Carbide blade inserted that can withstand the impact of mechanical fasteners which is used in most Longwall applications in underground Coal Mining. One of the main futures of our New MUS3 Cleaner is the minimum height requirement required for this cleaner.

FEATURES:

- Outstanding performance
- New M-TRAK design easy replacement & maintenance.
- Easy installation.
- Constant Air bag tensioning device.
- Long blade life.
- Also available in Polyurethane blade material and heat treated blade.
- Can be used on reversing conveyors and feeder belts.



MCS4 BELT CLEANER

The MATO MCS4 Belt Cleaning Unit is a multi-bladed in-line system, each blade is individually mounted with a rubber tensioning cushion to ensure even blade pressure and constant tip contact across the belt surface. The cleaner is designed to be slim-lined so it can fit into almost any position, taking up the minimal amount of room possible. The MCS4 Secondary Cleaner is suitable for all applications and works extremely well on high speed fully vulcanised belts or mechanically fastened belts, ensuring a clog-free operation. The cleaner is easy to install and maintain, and can be virtually installed anywhere on the belt.

FEATURES:

- Fits into confined spaces
- Outstanding performance on sticky material
- Easy installation and maintenance
- Various blade options
- Multi-bladed with individual cushion mounts
- Long blade life
- Ideally suited for mechanical fasteners

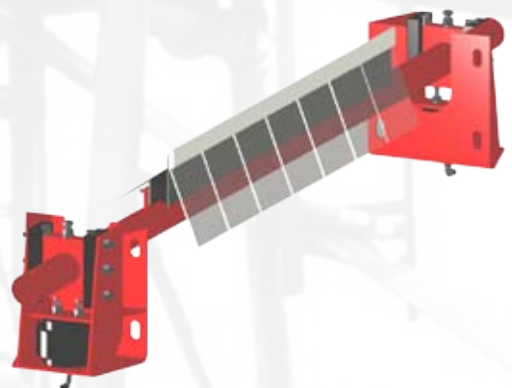

Returns Belt Cleaners

MATO

MCR1 VEE PLOUGH

The MATO MCR1 Vee plough is an economical free floating returns plough and is best suited installed prior to any returns belt pulley, tail pulley or loop take up installations.

The MCR1 has a robust construction, allowing for easy installation and recovery if needed. The MCR1 is supported by four chain anchor points to fix to any conveyor structure, thus allowing the unit to free float with varying belt conditions.

FEATURES:

- Easy blade replacement
- Economical
- Ease of installation
- Free floating



MCR2 DIAGONAL PLOUGH

The MATO MCR2 Diagonal plough has all the same features of the MCR1 Plough, however one blade assembled to the unit is designed to cover the entire width of the conveyor belt. This unit allows for all the materials removed by the plough to be deposited to the desired side of the conveyor belt. The MATO MCR2 diagonal Plough is easily changed from a right hand side configuration, to left hand side unit, as all the cleaner blades are interchangeable.

FEATURES:

- Single direction discharge
- Economical
- Ease of installation
- Free floating



MUR1 VEE PLOUGH

The MATO MUR1 Plough Type Belt Cleaner is a proven design that offers effective cleaning of the return belt, ease of maintenance and installation.

FEATURES:

- Profile urethane, replaceable, blade offers effective cleaning and protection of return pulley.
- Unique urethane tensioning system provides optimal tensioning of plough against belt.
- Ideally suited to use on belts with mechanical fasteners.
- Simple design of fabricated items provides ease of installation, maintenance and blade replacement.
- High quality paint finish optimizes life of fabricated components.



Belt Cleaners Accessories

TENSION SPRING ASSEMBLY

The tension spring assembly allows for constant tension to be applied on the cleaner unit, to cater for blade wear or greater movement for the blade surface on the head drum. This reduces the maintenance frequency for adjustment.

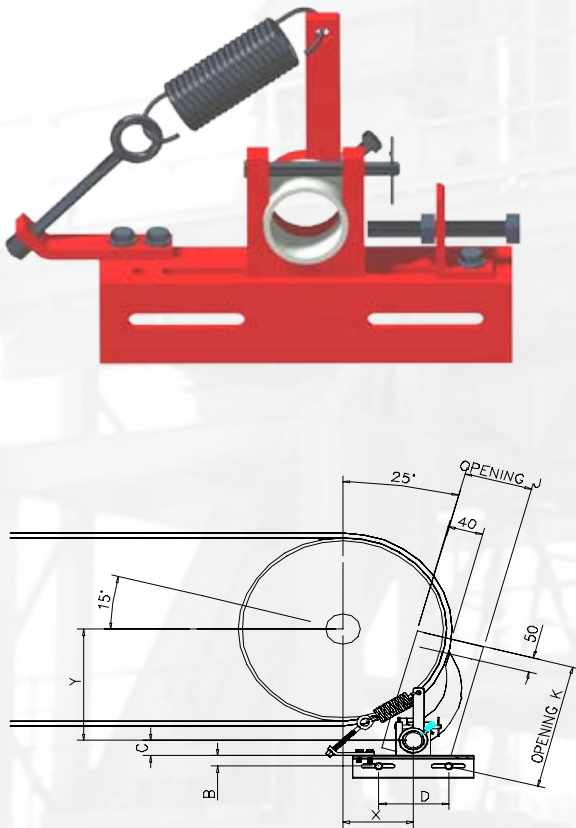

AIR BAG TENSION ASSEMBLY

The Air Bag End Assembly is one of our latest designs in constant performance for Belt Cleaner Tensioning devices. This Unique design of the air bag system for primary and secondary cleaners is by far our most successful tensioning device in today's market. When used on our MUP2 Primary cleaners the blade contact remains at its original 15 degrees set up for the entire blade wear, this improves the cleaning efficiently throughout the life of the polyurethane blade.

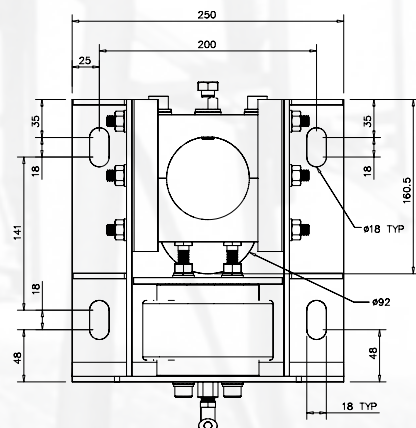

Dust Suppression Systems

MATO

IN-LINE WATER CONTROL UNIT

Spray board:

The In-line Water Control is a simple system to control the use of water sprays to operate on either belts running or product being conveyed.

IN-LINE WATER CONTROL UNIT

Spray control:

Our solenoid Water Manifold is an upgraded version of our In-line Water Control Unit, to encompass a filtration station, and a manual by-pass connection in case of power failures.

ULTRASONIC WATER CONTROL & BELT CLEANER CONTROL STATION

Ultrasonic control:

An ultrasonic beam senses product being conveyed to activate a variety of water or air valves for dust suppression and conveyor belt cleaner control. The system has variable options for power supply, and function, based on either belts running or products being detected.





www.mato.com.au



MATO
Australia Pty Ltd



MATO
Chile



MATO
China



MATO
USA



MATO
France



MATO
Germany



MATO
Spain



MATO
South Africa



MATO
Russia



MATO
Singapore



MATO
Switzerland



MATO
Ukraine



MATO
United Kingdom